

People • Technical • Quality

**HEMM**  
汉姆电机

- Smart Programmable Driver
- Integrated Stepper Servo
- Integrated Brushless DC motor
- Stepper Servo
- Brushless DC Servo
- AC Servo
- Stepper Motor Driver
- Stepper Motor
- Brushless Motor Driver
- DC Brushless MOTOR
- Accessories



### 常州汉姆电机有限公司

ChangZhou High Efficiency Motors CO.,LTD

Tel: +86 (0)519 83988139 Fax: +86 (0)519 83988139

Web:www.hemotors.com

Email:sales@hemotors.com

Address: No. A1-B3, No.18 Xinya Road,Wujin District,Changzhou City, Jiangsu Province, PRC

Post Code: 213160

### 华南办事处

South China office

Address: Room 303, floor 3, building 2, yungu phase 2, No.1 pingshan first road, nanshan district, Shenzhen City

Post Code: 518000

Tel: +86 13823506376



**电机**  
Motor



**驱动+控制**  
Driver+Control



**方案**  
Solution

## 常州汉姆电机有限公司

ChangZhou High Efficiency Motors CO.,LTD

■ Company Profile

Changzhou High Efficient Motors Co., Ltd is a professional manufacturer integrated with design and R&D, mainly providing stepper motors, DC Brushless motors, drivers and all motor solutions for global customers.

We possess deep strength in design and solutions. As our core, we have a professional engineering team comprising industry experts with talent and advanced technology, in the best effort to supply the most suitable hard and soft resolution of motors, drivers and controlling combination. Our Products are widely used in packaging, labelling, textile machinery, medical machinery, ceramic machining, printing machinery, OA, video monitoring, processing engine, robots and so on.

By focusing on quality and process, we are entirely trusted to supply high qualified, high performed and innovative products to our customers, keep our customers leading in the market.

Our mission is to provide more efficient, more performed products to customers by continuous technological innovation.

■ Content

Brushless DC Motors Naming Rule.....2

Brushless DC parameter table..... 3

Integrated Brushless DC Motors Naming Rule.....11

Integrated Brushless DC Motors.....11

Brushless Motor Driver Naming Rule.....14

Brushless Motor Driver.....15

Accessories.....20



Brushless DC Motors Naming Rule:

HEM - 23 BR 100 - 24 - 01 PG  
① ② ③ ④ ⑤ ⑥ ⑦

①	②	③	④	⑤	⑥	⑦
HEM	Nema Flange	Body Description	Power	Rated Voltage	Custome Model	Opition and customeration code
	11 28mm 17 42mm 23 57mm 24 60mm 32 80mm 34 86mm	BS Square type BR Round type		24:DC24V 48:DC48V A1:AC110 A2:AC220		IP: IP65 PG: Planetary gearbox BK: Brake ED: Encoder

Brushless DC motor parameter list

Series	Model	Voltage (VDC)	Power (w)	Rated speed (RPM)	Rated torque (N.m)	Length (mm)
Φ28 series	HEM-11BR6-15	15	6	8000	0.0072	26
	HEM-11BR15-24	24	15	3300	0.0435	75
□42 series	HEM-17BS30-24	24	30	4000	0.0715	45
	HEM-17BS30-48	48			0.0715	
	HEM-17BS60-24	24	60		0.143	70
	HEM-17BS60-48	48			0.143	
	HEM-17BS90-24	24	90		0.214	100
	HEM-17BS90-48	48			0.213	
Φ57 series	HEM-23BR50-24	24	50	4000	0.12	55
	HEM-23BR50-48	48			0.12	
	HEM-23BR100-24	24	100		0.24	75
	HEM-23BR100-48	48			0.24	
	HEM-23BR180-24	24	180		0.44	115
	HEM-23BR180-48	48			0.43	
□57 series	HEM-23BS50-24	24	50	4000	0.12	55
	HEM-23BS50-48	48			0.12	
	HEM-23BS100-24	24	100		0.24	75
	HEM-23BS100-48	48			0.24	
	HEM-23BS180-24	24	180		0.44	115
	HEM-23BS180-48	48			0.425	
□60 series	HEM-24BS60-24	24	60	3000	0.19	55
	HEM-24BS60-48	48			0.19	
	HEM-24BS120-24	24	120		0.38	75
	HEM-24BS120-48	48			0.38	
	HEM-24BS180-24	24	180		0.57	115
	HEM-24BS180-48	48			0.57	
□80 series	HEM-32BS100-24	24	100	4000	0.24	53
	HEM-32BS100-48	48			0.24	
	HEM-32BS200-24	24	200		0.48	73
	HEM-32BS200-48	48			0.48	
	HEM-32BS300-24	24	300		0.715	93
	HEM-32BS300-48	48			0.711	
□86 series	HEM-34BS200-48	48	200	3000	0.63	87
	HEM-34BS400-48	48	400		1.27	114

\* We can provide customized products, welcome to inquire

Φ28 Electrical Data

Item (Unit)	Three-phase brushless DC motor mode	
	HEM-11BR6-15	HEM-11BR15-24
Power voltage (VDC)	15	24
output power (W)	6	15
Length (mm)	26	75
poles	4	4
Rated torque(mN.m)	7.2	43.5
Rated current(A)	0.63	0.98
Rated speed(rpm)	8000	3300
Rotation speed (open loop rpm±10%)	10000	4500
Line to line resistance(Ω)	3.94	6.1
Line to line inductance (mH)	0.59	1.52
Back EMF constant (V.s/rad)	0.013	0.0475
Rotor inertia (g.cm <sup>2</sup> )	2.8	13.6
Weight (kg)	0.05	0.2
Senor	HALL	
Insulation class	E	
Degree of protection	IP40	
Operating temperature	0-----+50° C	
Storage temperature	-25-----+70° C	
Operating humidity	≤85%RH(Non_condensing)	

Dimensions(unit:mm)	
Model	Length(L)
HEM-11BR6-15	26
HEM-11BR15-24	75

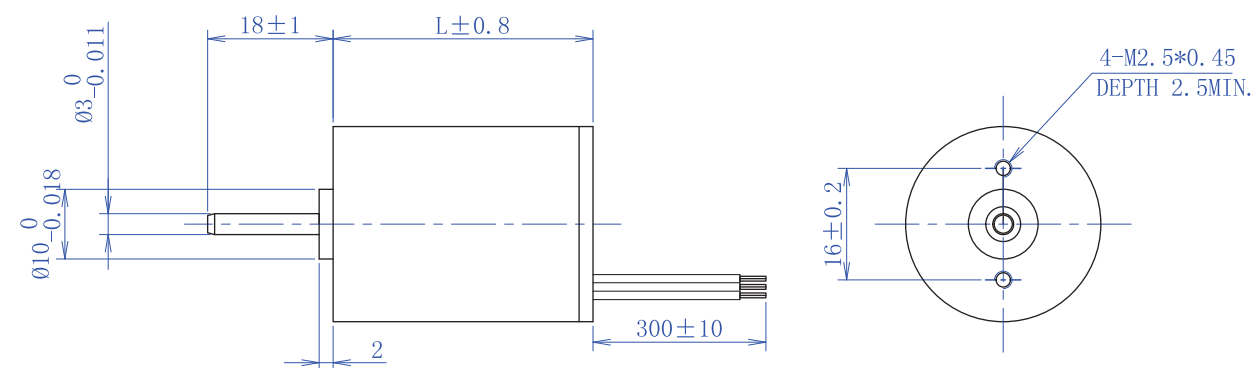

□42 Electrical Data

Item (Unit)	Three-phase brushless DC motor model					
	HEM-17BS30-24	HEM-17BS30-48	HEM-17BS60-24	HEM-17BS60-48	HEM-17BS90-24	HEM-17BS90-48
Power voltage (VDC)	24	48	24	48	24	48
Output power (W)	30		60		90	
Length (mm)	45		70		100	
Poles	8					
Rated torque(mN.m)	71.5	71.5	143	143	214	213
Rated current(A)	1.62	0.79	3.13	1.51	4.58	2.24
Rated speed(rpm)	4000					
Rotation speed (open loop rpm±10%)	4900	4900	5000	5000	4900	4900
Line to line resistance(Ω)	1.4	6.01	0.66	2.53	0.38	1.65
Line to line inductance (mH)	1.18	4.91	0.67	2.84	0.23	1.89
Back EMF constant (V.s/rad)	0.0441	0.09	0.044	0.091	0.045	0.091
Rotor inertia (g.cm <sup>2</sup> )	0.047		0.077		0.114	
Weight (kg)	0.32		0.52		0.77	
Senor	HALL					
Insulation class	E					
Degree of protection	IP40					
Operating temperature	0-----+50° C					
Storage temperature	-25-----+70° C					
Operating humidity	≤85%RH (Non_condensing)					

Dimensions(unit:mm)	
Model	Length(L)
HEM-17BS30series	45
HEM-17BS60series	70
HEM-17BS90series	100

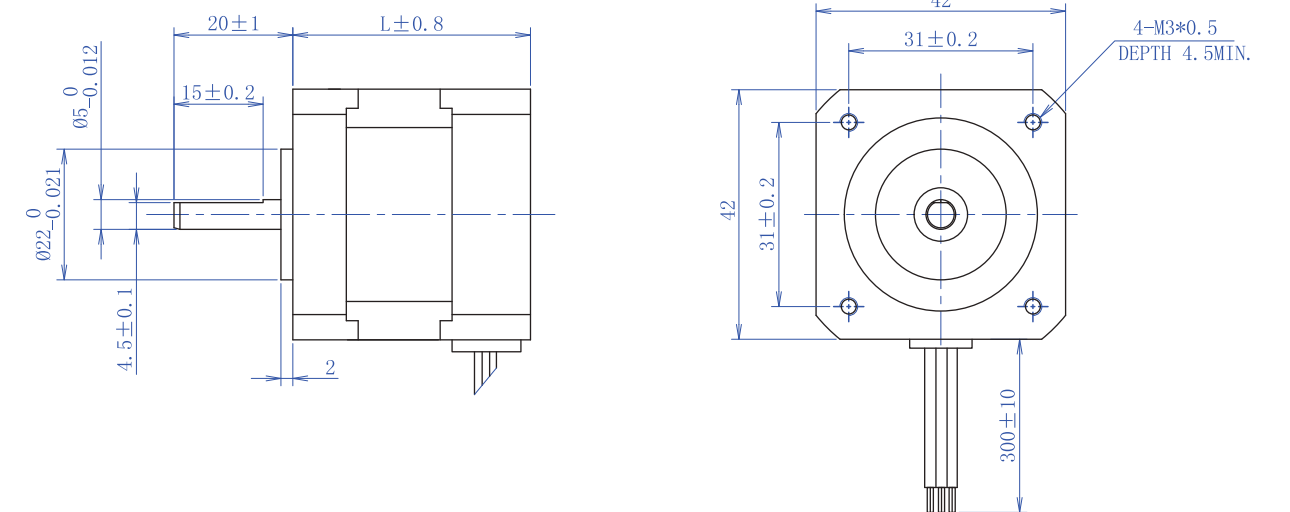

More product information [www.hemotors.com](http://www.hemotors.com)

Φ57 Electrical Data

Item (Unit)	Three-phase brushless DC motor model					
	HEM-23BR50-24	HEM-23BR50-48	HEM-23BR100-24	HEM-23BR100-48	HEM-23BR180-24	HEM-23BR180-48
Power voltage (VDC)	24	48	24	48	24	48
Length (mm)	55		75		115	
Output power (W)	50		100		180	
Poles	4					
Rated torque(mN.m)	0.12	0.12	0.24	0.24	0.44	0.43
Rated current(A)	2.65	1.32	5.1	2.49	8.95	4.24
Rated speed(rpm)	4000					
Rotation speed (open loop rpm±10%)	4800	4900	4700	4700	4500	4500
Line to line resistance(Ω)	0.82	3.84	0.34	1.48	0.14	0.54
Line to line inductance (mH)	1.24	4.98	0.64	2.66	0.34	1.44
Back EMF constant (V.s/rad)	0.046	0.0911	0.046	0.095	0.049	0.1
Rotor inertia (g.cm <sup>2</sup> )	0.171		0.342		0.384	
Weight (kg)	0.51		0.85		1.25	
Senor	HALL					
Insulation class	E					
Degree of protection	IP40					
Operating temperature	0-----+50° C					
Storage temperature	-25-----+70° C					
Operating humidity	≤85%RH(Non_condensing)					

Dimensions(unit:mm)	
Model	Length(L)
HEM-23BR50 series	55
HEM-23BR100 series	75
HEM-23BR180 series	115

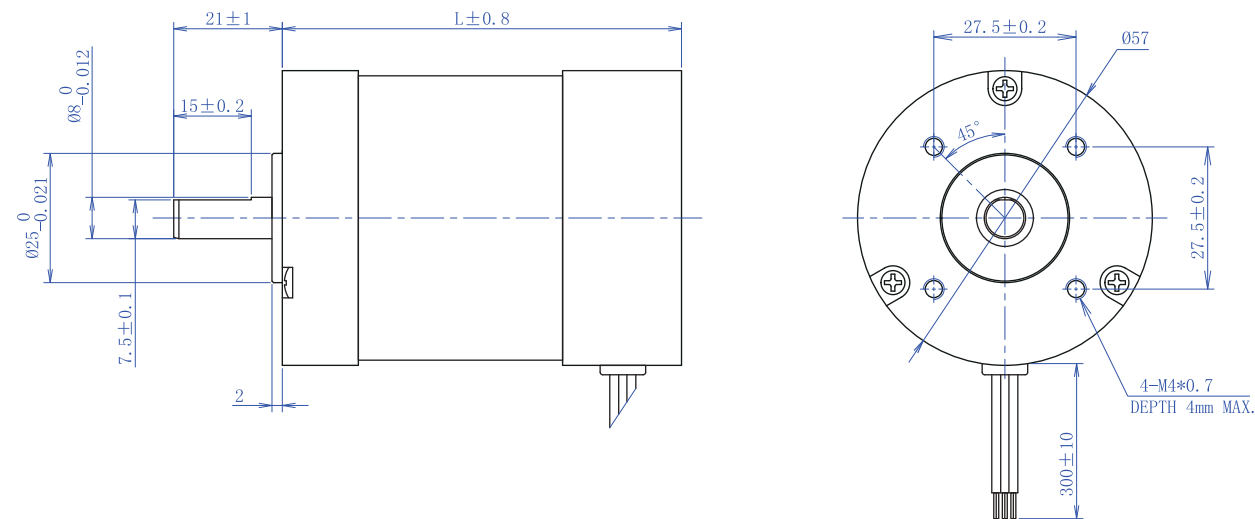

□57 Electrical Data

Item (Unit)	Three-phase brushless DC motor model					
	HEM-23BS50-24	HEM-23BS50-48	HEM-23BS100-24	HEM-23BS100-48	HEM-23BS180-24	HEM-23BS180-48
Power voltage (VDC)	24	48	24	48	24	48
Length (mm)	55		75		115	
Output power (W)	50		100		180	
Poles	8					
Rated torque(mN.m)	0.12	0.12	0.24	0.24	0.44	0.425
Rated current(A)	2.65	1.29	5.13	2.5	9.14	4.44
Rated speed(rpm)	4000					
Rotation speed (open loop rpm±10%)	4600	4700	4600	4600	4400	4500
Line to line resistance(Ω)	0.68	2.86	0.28	1.18	0.14	0.53
Line to line inductance (mH)	0.49	0.196	0.24	1.01	0.13	0.52
Back EMF constant (V.s/rad)	0.048	0.096	0.0475	0.097	0.05	0.099
Rotor inertia (g.cm <sup>2</sup> )	0.171		0.342		0.384	
Weight (kg)	0.6		0.94		1.34	
Senor	HALL					
Insulation class	E					
Degree of protection	IP40					
Operating temperature	0-----+50° C					
Storage temperature	-25-----+70° C					
Operating humidity	≤85%RH(Non_condensing)					

Dimensions(unit:mm)	
Model	Length(L)
HEM-23BS50 series	55
HEM-23BS100 series	75
HEM-23BS180 series	115

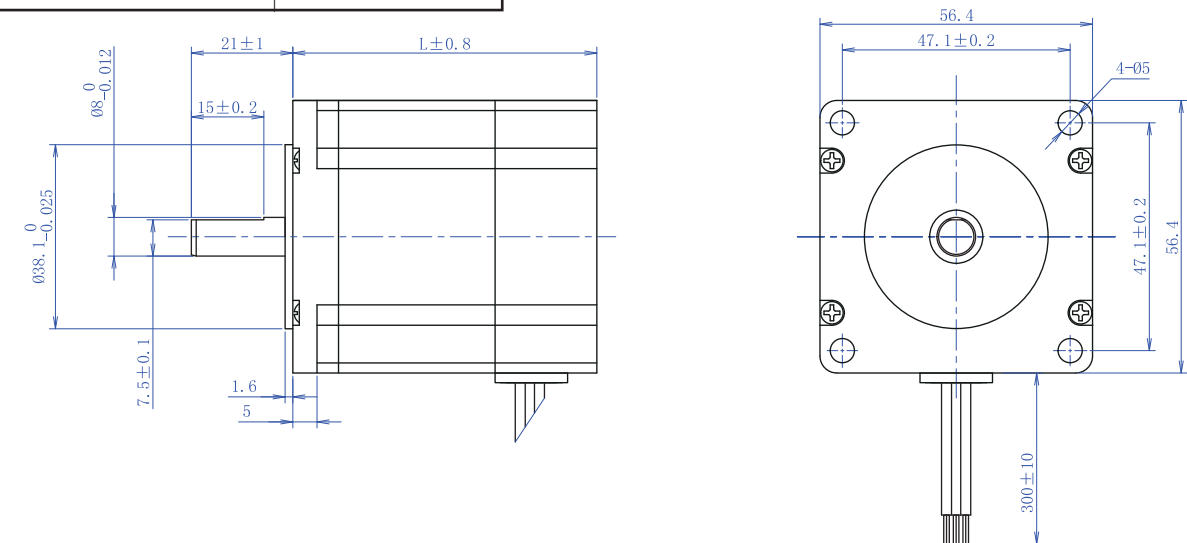

More product information } [www.hemotors.com](http://www.hemotors.com)

60 Electrical Data

Item (Unit)	Three-phase brushless DC motor model					
	HEM-24BS60-24	HEM-24BS60-48	HEM-24BS120-24	HEM-24BS120-48	HEM-24BS180-24	HEM-24BS180-48
Power voltage (VDC)	24	48	24	48	24	48
Length (mm)	55		75		115	
Output power (W)	60		120		180	
Poles	6					
Rated torque(mN.m)	0.19	0.19	0.38	0.38	0.57	0.57
Rated current(A)	3.15	1.55	6.13	3	9.11	4.44
Rated speed(rpm)	3000					
Rotation speed (open loop rpm±10%)	3400	3500	3400	3500	3400	3400
Line to line resistance(Ω)	0.52	2.4	0.25	1.06	0.16	0.66
Line to line inductance (mH)	0.55	2.28	0.32	1.31	0.22	0.92
Back EMF constant (V.s/rad)	0.064	0.13	0.066	0.131	0.064	0.131
Rotor inertia (g.cm <sup>2</sup> )	0.115		0.207		0.3	
Weight (kg)	0.43		0.73		1.04	
Senor	HALL					
Insulation class	E					
Degree of protection	IP40					
Operating temperature	0-----+50° C					
Storage temperature	-25-----+70° C					
Operating humidity	≤85%RH (Non_condensing)					

Dimensions(unit:mm)	
Model	Length(L)
HEM-24BS60series	55
HEM-24BS120series	75
HEM-24BS180series	115

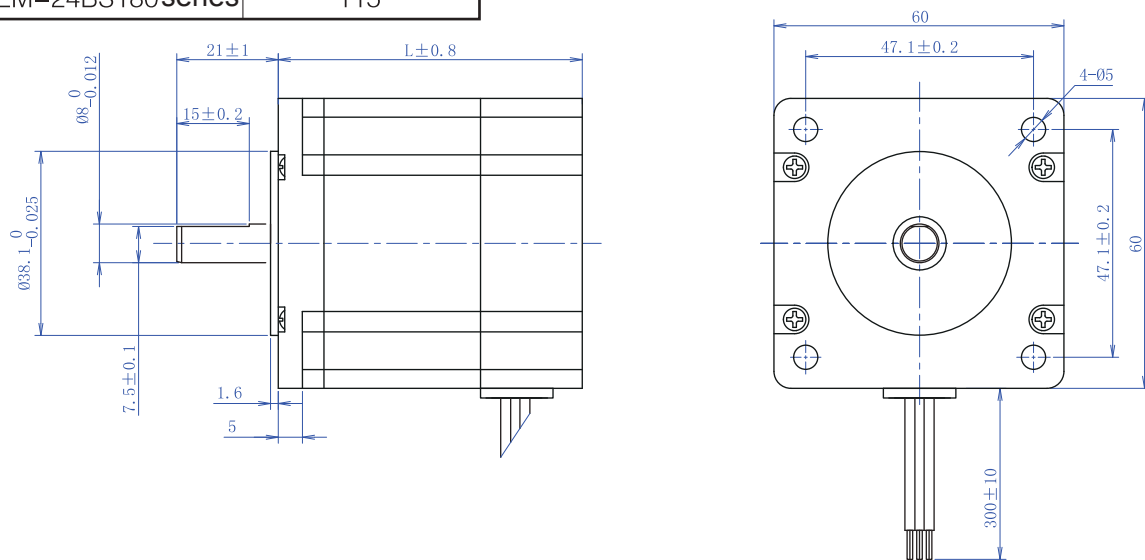

80 Electrical Data

Item (Unit)	Three-phase brushless DC motor model					
	HEM-32BS100-24	HEM-32BS100-48	HEM-32BS200-24	HEM-32BS200-48	HEM-32BS300-24	HEM-32BS300-48
Power voltage (VDC)	24	48	24	48	24	48
Length (mm)	53		73		93	
Output power (W)	100		200		300	
Poles	8					
Rated torque(mN.m)	0.24	0.24	0.48	0.48	0.715	0.711
Rated current(A)	4.93	2.46	9.58	4.82	14.8	7.21
Rated speed(rpm)	4000					
Rotation speed (open loop rpm±10%)	4600	4500	4500	4500	4500	4500
Line to line resistance(Ω)	0.2	0.8	0.072	0.3	0.046	0.18
Line to line inductance (mH)	0.324	1.31	0.154	0.66	0.1	0.434
Back EMF constant (V.s/rad)	0.049	0.1	0.049	0.101	0.049	0.1
Rotor inertia (g.cm <sup>2</sup> )	0.512		0.924		1.336	
Weight (kg)	0.81		1.4		2.02	
Senor	HALL					
Insulation class	E					
Degree of protection	IP40					
Operating temperature	0-----+50° C					
Storage temperature	-25-----+70° C					
Operating humidity	≤85%RH (Non_condensing)					

Dimensions(unit:mm)	
Model	Length(L)
HEM-32BS100series	53
HEM-32BS200series	73
HEM-32BS300series	93

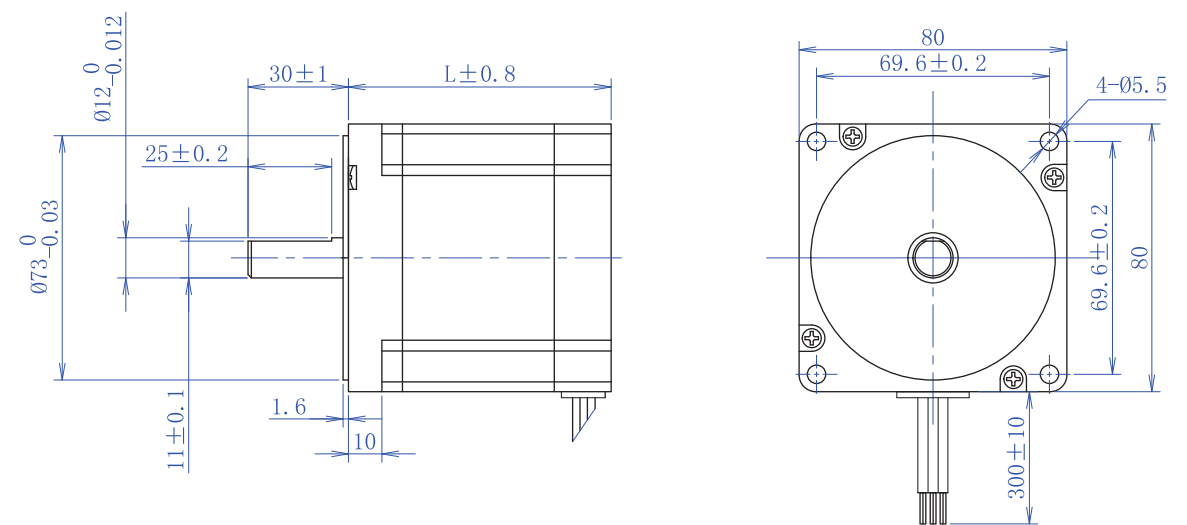

86 Electrical Data

Item (Unit)	Three-phase brushless DC motor model	
	HEM-34BS200-48	HEM-34BS400-48
Power voltage (VDC)	48	48
Length (mm)	87	114
Output power (W)	200	400
Poles	8	
Rated torque(mN.m)	0.63	1.27
Rated current(A)	4.79	9.45
Rated speed(rpm)	3000	
Rotation speed (open loop rpm±10%)	3500	3500
Line to line resistance(Ω)	0.44	0.2
Line to line inductance (mH)	0.76	0.41
Back EMF constant (V.s/rad)	0.131	0.132
Rotor inertia (g.cm <sup>2</sup> )	1.21	2.3
Weight (kg)	1.8	2.8
Senor	HALL	
Insulation class	E	
Degree of protection	IP40	
Operating temperature	0-----+50° C	
Storage temperature	-25-----+70° C	
Operating humidity	≤85%RH (Non_condensing)	

Dimensions(unit:mm)	
Model	Length(L)
HEM-34BS200series	87
HEM-34BS400series	114

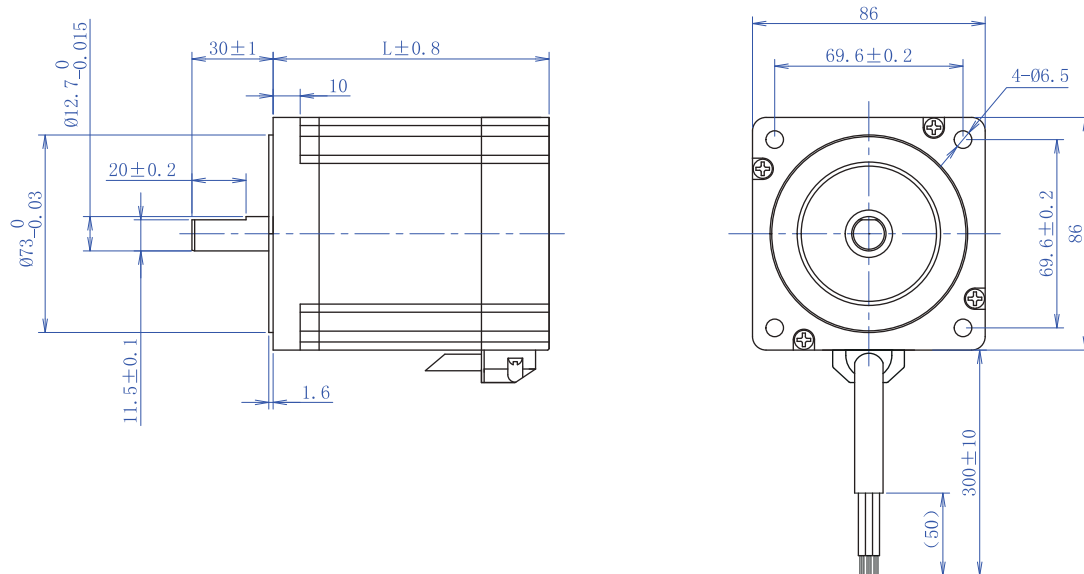

① H    ② TSM    ③ 23    ④ W60 - ⑤ 24 - ⑥ 01    ⑦ PG

①	②	③	④	⑤	⑥	⑦
HEM	Motor Type	Nema Flange	Power	Rated Voltage	Custome Model	Option and customization code
	TSM: Integrated Brushless DC	11 28mm		24:DC24V		IP: IP65
		17 42mm		48:DC48V		PG: Planetary gearbox
		23 57mm		A1:AC110		BK: Brake
		32 80mm		A2:AC220		

Integrated brushless DC motor:

Item (Unit)	Three-phase brushless DC motor model		
	HTSM17W60-24	HTSM23W50-24	HTSM32W100-24
Power voltage (VDC)	24	24	24
Length (mm)	42	57	80
Output power (W)	70	70	58
Poles	60	50	100
Rated torque(mN.m)	8		
Rated current(A)	0.14	0.12	0.24
Rated speed(rpm)	3.13	2.65	4.93
Rotation speed (open loop rpm±10%)	4000		
Line to line resistance(Ω)	5000	4800	4600
Line to line inductance (mH)	0.66	0.82	0.2
Back EMF constant (V.s/rad)	0.67	1.24	0.324
Rotor inertia (g.cm <sup>2</sup> )	0.044	0.046	0.049
Weight (kg)	0.077	0.171	0.512
Senor	HALL	NO	HALL
Insulation class	E		
Degree of protection	IP40		
Operating temperature	0-----+50° C		
Storage temperature	-25-----+70° C		
Operating humidity	≤85%RH (Non_condensing)		

Electrical Data

Motor model	HTSM17W60-24
Voltage	24VDC
Velocity control	Analog input(0V~5V)
Tacho output	One cycle corresponds to one pulse
Driver mode	Integrated brushless motor with built-in drive circuit
Modulation Mode	Square wave
Protect function	Over Voltage、Over current、Locked-rotor、Anti-reverse connection
Summarize	The integrated brushless dc motor adopts the closed-loop circuit design, which has the characteristics of quick speed regulation response and strong anti-interference. With positive and negative rotation, manual speed regulation, speed feedback and other functions

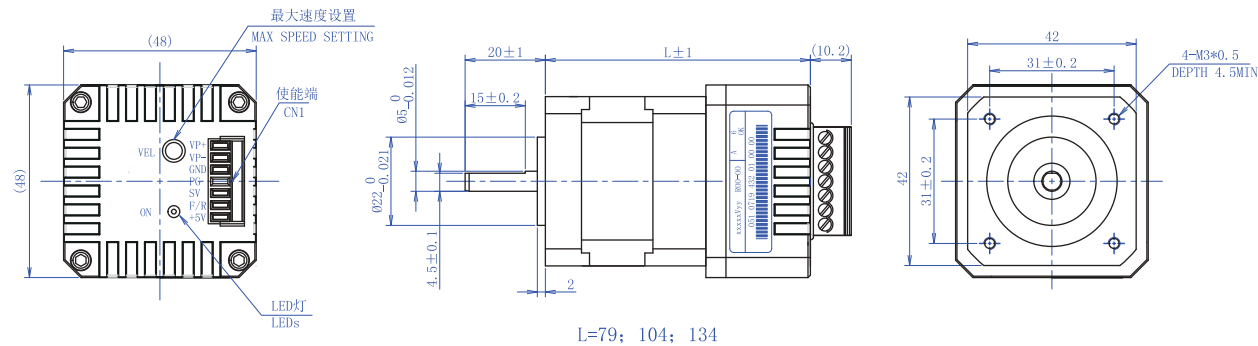

L=79; 104; 134

Electrical Data

Motor model	HTSM23W50-24
Voltage	24VDC
Velocity control	Analog input(0V~5V)
Tacho output	One cycle corresponds to one pulse
Driver mode	Integrated brushless motor with built-in drive circuit
Modulation Mode	Square wave
Protect function	Over Voltage、Over current、Locked-rotor、Anti-reverse connection
Summarize	The integrated brushless dc motor adopts the closed-loop circuit design, which has the characteristics of quick speed regulation response and strong anti-interference. With positive and negative rotation, manual speed regulation, speed feedback and other functions

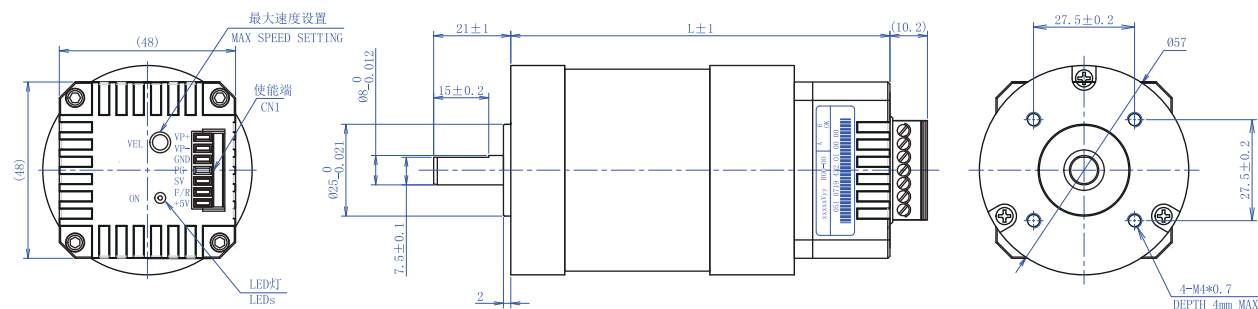

L=84; 134; 214

Electrical Data

Motor model	HTSM32W100-24
Voltage	24VDC
Velocity control	Analog input(0V~5V)
Tacho output	One cycle corresponds to one pulse
Driver mode	Integrated brushless motor with built-in drive circuit
Modulation Mode	Square wave
Protect function	Over Voltage、Over current、Locked-rotor、Anti-reverse connection
Summarize	The integrated brushless dc motor adopts the closed-loop circuit design, which has the characteristics of quick speed regulation response and strong anti-interference. With positive and negative rotation, manual speed regulation, speed feedback and other functions

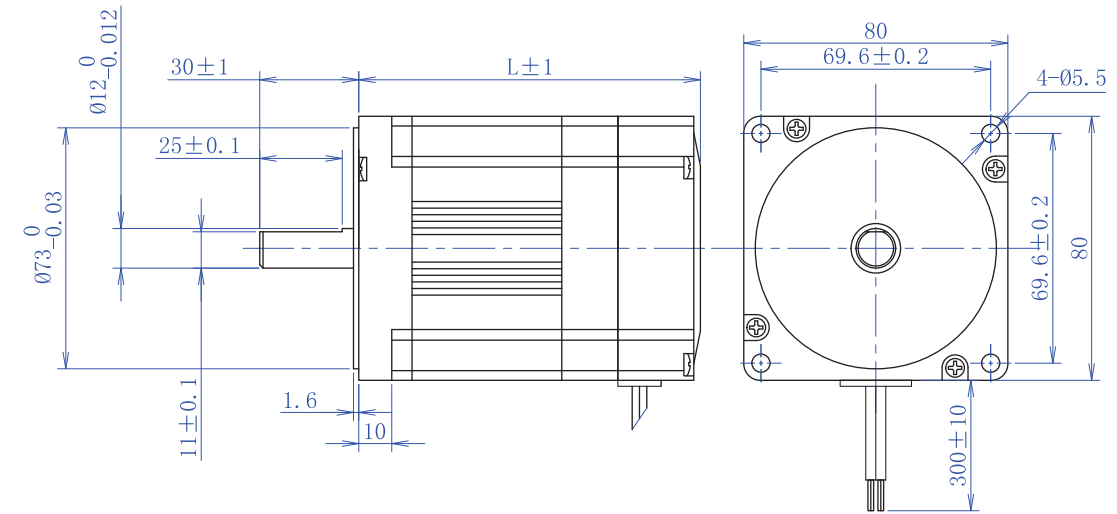

Brushless DC motor Drive Naming Rule:

H                      DBD                      70W                      8A                      -                      R4  
①                                      ②                                      ③                                      ④                                      ⑤

①	②	③	④	⑤
HEM	Drive type	Maximum power	Rated current	Communication Ports
	DBD: Brushless DC motor	70W:70W 120W:120W 300W:300W 1500W:1500W	3A:3A 8A:8A 15A:15A 75A:75A	无: Brushless DC motor R4: RS485 R2: RS232

Brushless DC motor Drive HDBD70W-3A

- Features:
  - Can drive less than 70W brushless motor
  - Functions: braking, positive and negative rotation and switching
  - Functions: Over temperature, Over current, Hall error
  - This Onboard potentiometer can be used for adjusting speed.
  - External digital and analog signal setting speed.
  - Small size, easy to install.



Electrical Data

Parameter	Min	Type	Max	Unit
Power supply	12	24	30	VDC
Output Current	-	-	3	A
overvoltage protection	-	30	-	VDC
undervoltage protection	-	12	-	VDC
External potentiometer	-	10K	-	Ω
Input analog signal voltage	-	-	5	VDC
Speed range	-	-	20000	r/min

Dimensions(unit:mm)

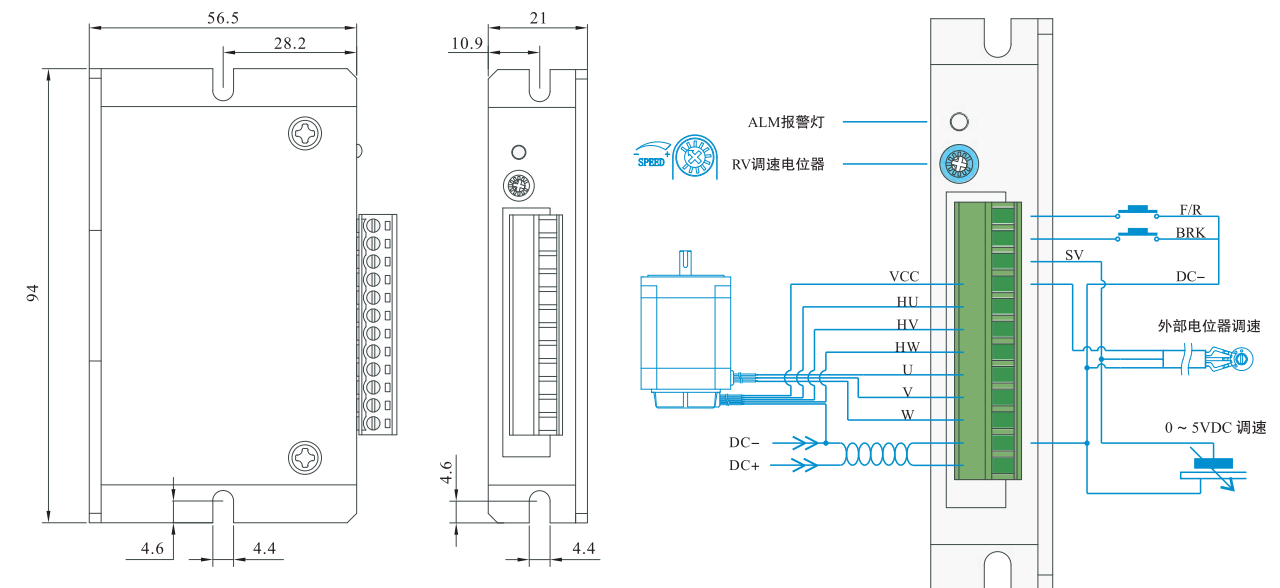

### Brushless DC motor Drive HDBD120W-8A

#### Features:

- Can drive less than 120W brushless motor
- Setting the acceleration and deceleration
- The power protection function(Maximum current setting)
- This Onboard potentiometer can be used for adjusting speed.
- External digital and analog signal setting speed.
- PWM speed adjusting
- Motor pole number setting、 Open loop and closed loop control、 Various alarm prompts



### Electrical Data

Parameter	Min	Type	Max	Unit
Power supply	12	24	30	VDC
Output Current	-	-	8	A
overvoltage protection	-	-	5	V
undervoltage protection	-	20	-	mA
External potentiometer		10K		Ω
Input analog signal voltage	-	-	5	VDC
Speed range	-	-	20000	r/min

#### Dimensions(unit:mm)

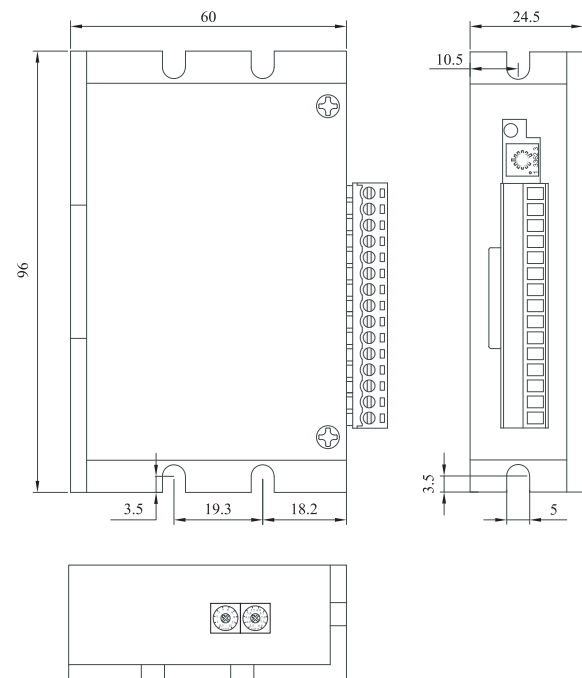

#### Control signal interface:

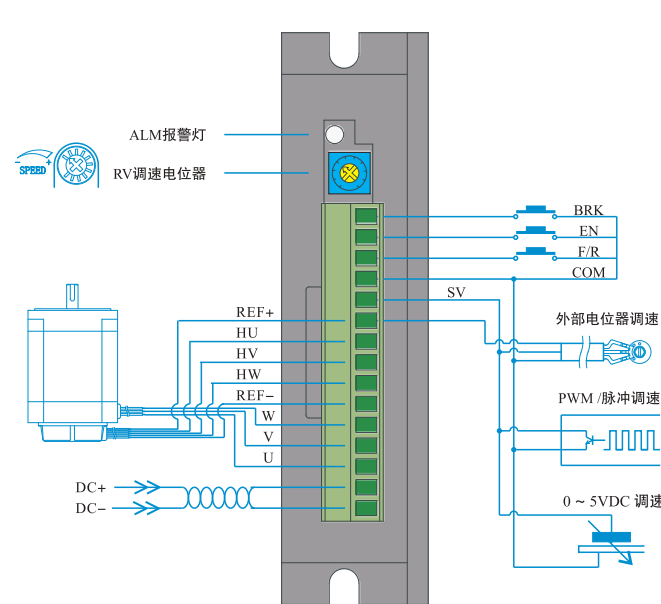

### Brushless DC motor Drive HDBD300W-15A

#### Features:

- Can drive less than 300W brushless motor
- Setting the acceleration and deceleration
- The power protection function(Maximum current setting)
- This Onboard potentiometer can be used for adjusting speed.
- External digital and analog signal setting speed.
- Small size, easy to install.



### Electrical Data

Parameter	Min	Type	Max	Unit
Power supply	12	48	56	VDC
Output Current	-	-	15	A
Hall signal voltage	-	-	5	V
Hall drive current	12	-	-	mA
External potentiometer		10K		Ω
Speed range	-	-	20000	r/min

#### Dimensions(unit:mm)

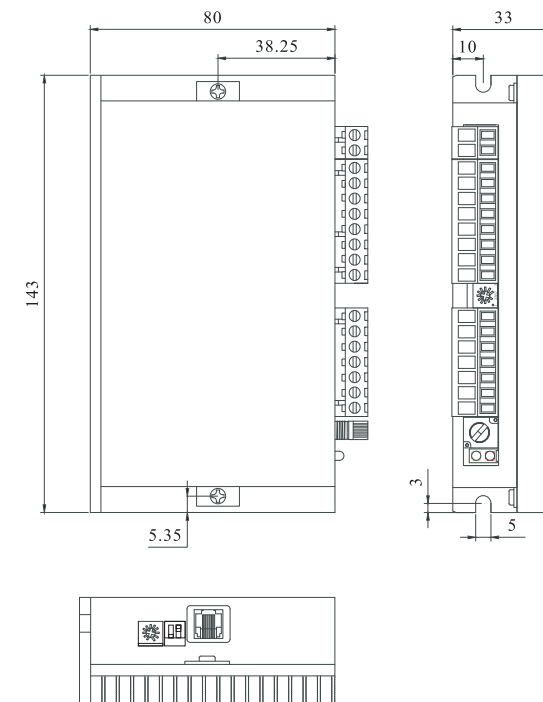

#### Control signal interface:

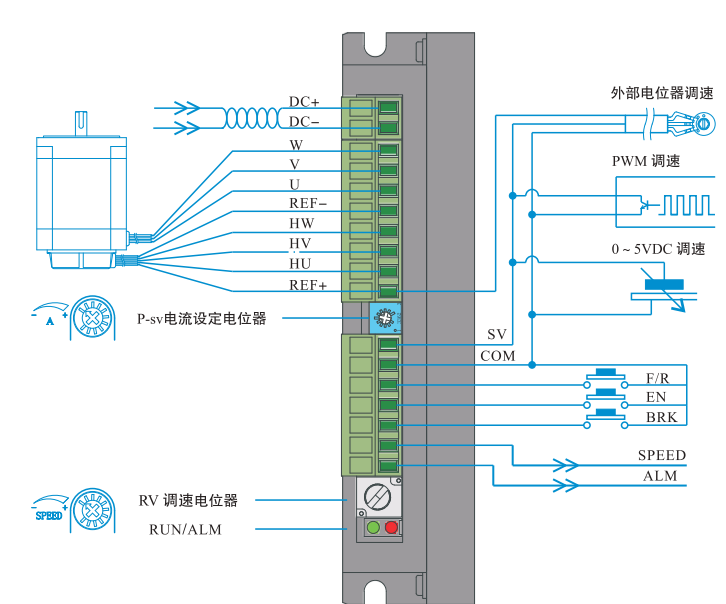

### Brushless DC motor Drive HDBD120W-8A-R4

#### Features:

- Setting the acceleration and deceleration
- The power protection function(Maximum current setting)
- This Onboard potentiometer can be used for adjusting speed.
- External digital and analog signal setting speed.
- PWM speed adjusting
- RS485 communication multi-axis control、Open loop and closed loop control、Various alarm prompts



### Electrical Data

Parameter	Min	Type	Max	Unit
Power supply	20	24	50	VDC
Output Current	-	-	8	A
Hall signal voltage	-	-	5	V
Hall drive current	12	-	-	mA
External potentiometer		10K		Ω
Speed range	-	-	20000	r/min

#### Dimensions(unit:mm)

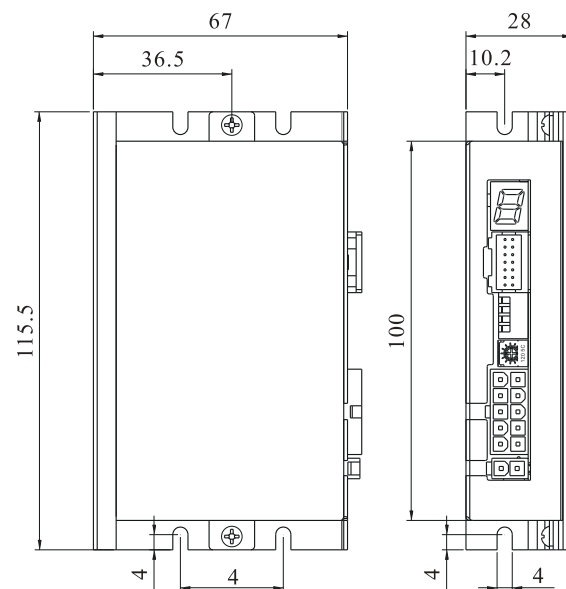

#### Control signal interface:

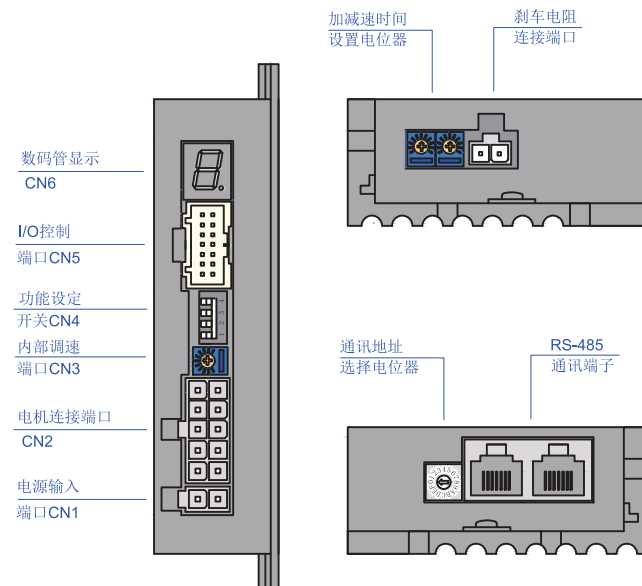

### Brushless DC motor Drive HDBD1500W-75A-R

#### Features:

- Setting the acceleration and deceleration
- The power protection function(Maximum current setting)
- This Onboard potentiometer can be used for adjusting speed.
- External digital and analog signal setting speed.
- PWM speed adjusting
- RS485 communication multi-axis control、Open loop and closed loop control、Various alarm prompts



### Electrical Data

Parameter	Min	Type	Max	Unit
Power supply	24	48	48	VDC
Output Current	-	-	75	A
Hall signal voltage	-	-	5	V
Hall drive current	12	-	-	mA
External potentiometer		10K		Ω
Speed range	-	-	20000	r/min

#### Dimensions(unit:mm)

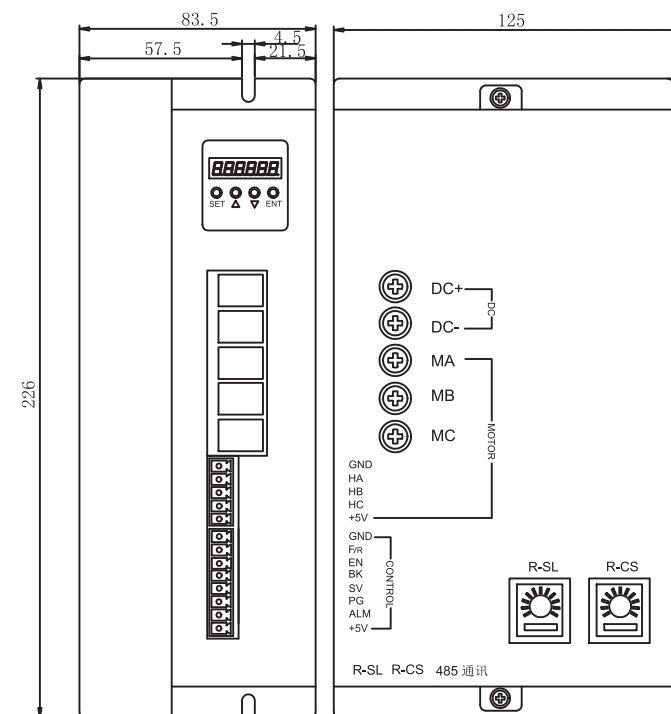

#### Control signal interface:

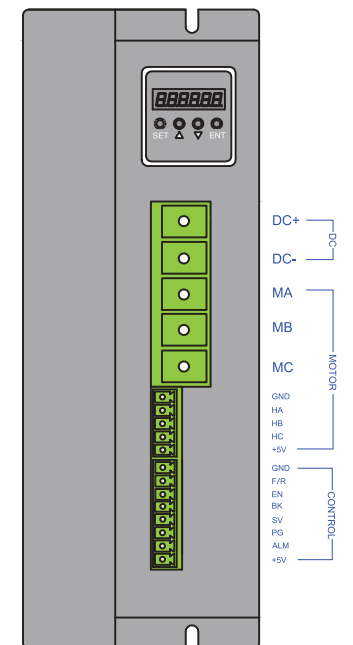

电机配件  
Motor parts

电机配件  
Motor parts

■ Damper | Gearbox

■ Pulley | Gear

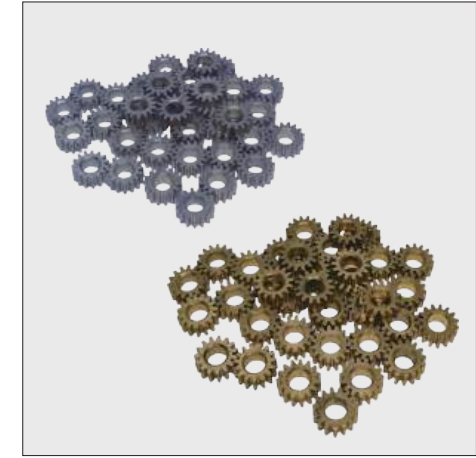

Damper

Gearbox

Pulley

Gear

■ Flexible coupling | Connection Cables

■ Encoder | Brake

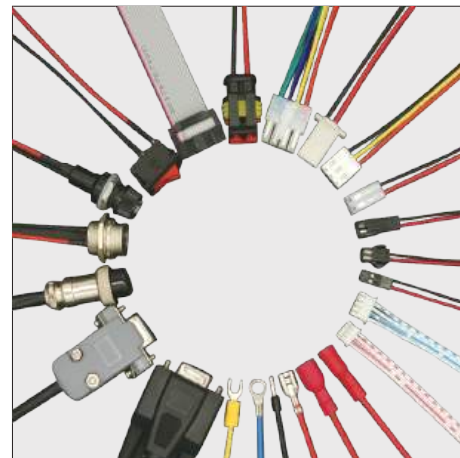

Made in Japan

Flexible coupling

Connection Cables

Encoder

Brake

Damper

Damper

Gearbox

Gearbox

Flexible coupling

Flexible coupling

Connection Cables

Connection Cables

Pulley

Pulley

Gear

Gear

Encoder

Encoder

Brake

Brake

People • Technical • Quality

**HEMM**  
汉姆电机

- Smart Programmable Driver
- Integrated Stepper Servo
- Integrated Brushless DC motor
- Stepper Servo
- Brushless DC Servo
- AC Servo
- Stepper Motor Driver
- Stepper Motor
- Brushless Motor Driver
- DC Brushless MOTOR
- Accessories

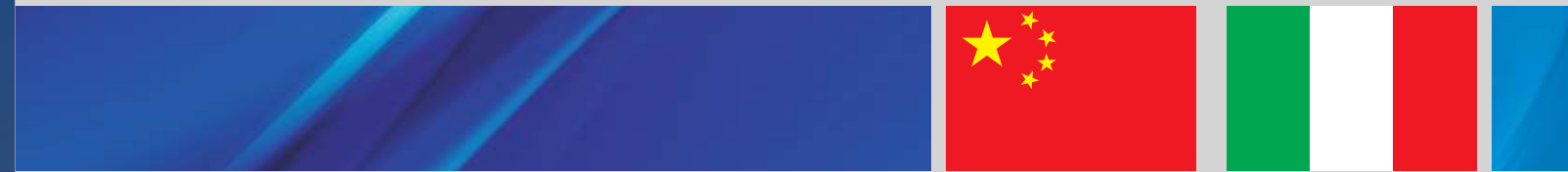

**常州汉姆电机有限公司**

ChangZhou High Efficiency Motors CO.,LTD

Tel: +86 (0)519 83988139 Fax: +86 (0)519 83988139

Web:www.hemotors.com

Email:sales@hemotors.com

Address: No. A1-B3, No.18 Xinya Road,Wujin District,Changzhou City, Jiangsu Province, PRC

Post Code: 213160

**华南办事处**

South China office

Address: Room 303, floor 3, building 2, yungu phase 2, No.1 pingshan first road, nanshan district, Shenzhen City

Post Code: 518000

Tel: +86 13823506376



**电机**  
Motor



**驱动+控制**  
Driver+Control

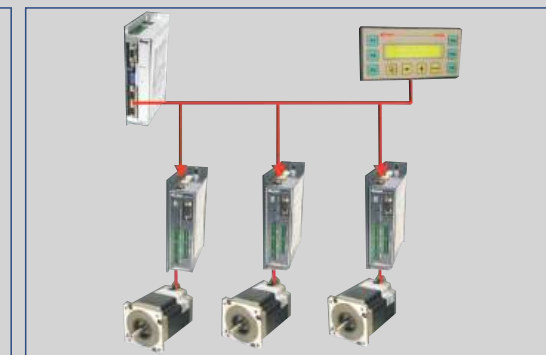

**方案**  
Solution

**常州汉姆电机有限公司**

ChangZhou High Efficiency Motors CO.,LTD

■ Company Profile

Changzhou High Efficient Motors Co., Ltd is a professional manufacturer integrated with design and R&D, mainly providing stepper motors, DC Brushless motors, drivers and all motor solutions for global customers.

We possess deep strength in design and solutions. As our core, we have a professional engineering team comprising industry experts with talent and advanced technology, in the best effort to supply the most suitable hard and soft resolution of motors, drivers and controlling combination. Our Products are widely used in packaging, labelling, textile machinery, medical machinery, ceramic machining, printing machinery, OA, video monitoring, processing engine, robots and so on.

By focusing on quality and process, we are entirely trusted to supply high qualified, high performed and innovative products to our customers, keep our customers leading in the market.

Our mission is to provide more efficient, more performed products to customers by continuous technological innovation.



■ CONTENT

Stepper Motors Driver Naming Rule.....2

Two phase DC stepper drive..... 3

Two phase AC stepper drive.....6

Three phase DC stepper drive.....8

Three phase AC stepper drive.....9

Stepper Motors Naming Rule.....10

Stepper motors total parameter table.....11

Three phase stepper motor.....12

Three phase stepper motor..... 21

Hercules motor.....23

Waterproof motor.....24

Encoder motor.....26

Brake motor.....29

Planetary gearbox motor.....31

Outdoor anti-rust motor.....33

Accessories.....34

步进驱动器  
STEPPER DRIVE

2 phase  
DC

2 phase  
AC

3 phase  
DC

3 phase  
AC

步进电机  
STEPPER MOTOR

2 phase  
stepper motor

3 phase  
stepper motor

Hercules  
motor

Waterproof  
motor

Encoder  
motor

Brake  
motor

Planetary gearbox  
motor

Outdoor anti-rust  
motor

### Stepper Motors Driver Naming Rule:

$\frac{H}{①}$      $\frac{D}{②}$      $\frac{SD}{③}$      $\frac{2}{④}$      $\frac{4}{⑤}$      $\frac{5}{⑥}$  -  $\frac{R2}{⑦}$

①	②	③	④	⑤	⑥	⑦
HEMM	Power Type	Series	Phases Number	Rated Current	Rated Voltage	Communication Mode
	D:DC power A:AC power	SD:Stepper Motors Driver		1-9:Current Intensity	AC power 1: AC110V 2: AC220V  DC power: The number represents the maximum voltage supplied	None: Standard R2: RS232 R4: RS485

### Step motor drive product parameters:

Phases Number	Name	Model	Current(rms)	Input voltage	Control mode	Microstep selection	Current selection
2 phase	I-Drive2	HDSD224	0.1-1.5A	8-36VDC	SD	16 position (2 or 5)	16 position
	I-Drive4	HDSD245	1-4A	24-48VDC	SD		8 position
	I-Drive7	HDSD278	3.2-7A	24-80VDC	SD		16 position
	A5	HASD252	0.5-5A	AC90-240V	SD		16 position
	A7	HASD272	1.2-7A	AC90-240V	SD		16 position
3 phase	3I-Drive4	HDSD348	0.2-3.2A	24-80VDC	SD	16 position (2 or 5)	16 position
	3I-Drive7	HDSD378	3.2-7A	24-80VDC	SD		16 position
	3A5	HASD352	1.2-5A	AC90-240V	SD		16 position
	3A7	HASD372	1.2-7A	AC90-240V	SD		16 position

For detailed specifications, please contact HEMM or download from the website:www.hemotors.com

### Two phase DC stepper drive HDSD224

#### Features:

- PID current control, low noise, low vibration, low heat;
- The output current of the step drive is set by the DIP switch, there are 16 settings, The peak current can reach 2.2A;
- Input voltage: 8-36VDC;
- Protection: over voltage, under voltage, over current, open motor winding;
- Optical isolation signal input/output;
- When the stepping pulse stops for more than 1S, the current will be automatically halved and theoretically reduced to 25% when heated.

### Electrical specifications

Parameter	Min	Typical	Max	Unit
Power supply	8	24	36	VDC
Output Current	0.2	-	2.2	Apeak
Input signal voltage	3.3	-	28	VDC
Current of control signal	6	10	16	mA
Step frequency	0	-	300	KHZ

#### Dimensions (unit: mm):

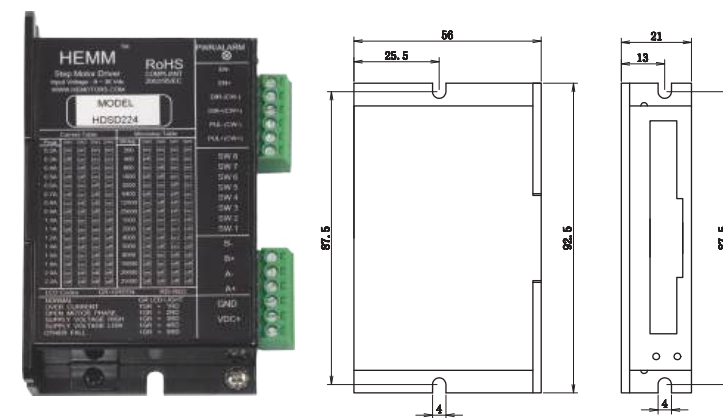

#### Connection interface:

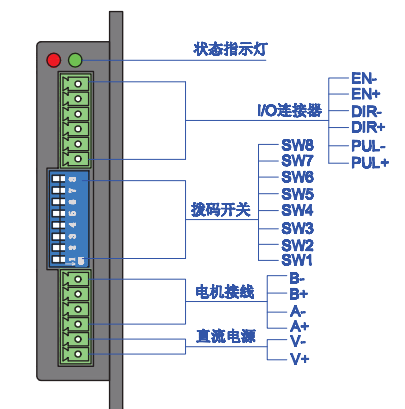

Two phase DC stepper drive HDSD245

Features:

- PID current control, low noise, low vibration, low heat;
- The output current of the step drive is set by the DIP switch, there are 8 settings, The peak current can reach 5.6A;
- Input voltage: 24-48VDC;
- Protection: over voltage, under voltage, over current, open motor winding;
- Optical isolation signal input/output;
- Automatically calculate the system's natural frequency to improves midrange stability;
- At start-up the drive measure motor parameters, including the resistance and inductance, to optimize system performance.

Two phase DC stepper drive HDSD278

Features:

- PID current control, low noise, low vibration, low heat;
- The output current of the step drive is set by the DIP switch, there are 16 settings, The peak current can reach 10A;
- Input voltage: 24-80VDC;
- Protection: over voltage, under voltage, over current, open motor winding;
- Optical isolation signal input/output;
- Automatically calculate the system's natural frequency to improves midrange stability;
- At start-up the drive measure motor parameters, including the resistance and inductance, to optimize system performance.

Electrical specifications

Parameter	Min	Typical	Max	Unit
Power supply	24	24	48	VDC
Output Current	1.4	-	5.6	Apeak
Input signal voltage	3.3	-	24	VDC
Current of control signal	6	10	16	mA
Step frequency	0	-	200	KHZ

Electrical specifications

Parameter	Min	Typical	Max	Unit
Power supply	24	48	80	VDC
Output Current	2.4	-	10	Apeak
Input signal voltage	2	-	24	VDC
Current of control signal	-	-	8.75	mA
Step frequency	0	-	10	KHZ

Dimensions (unit: mm):

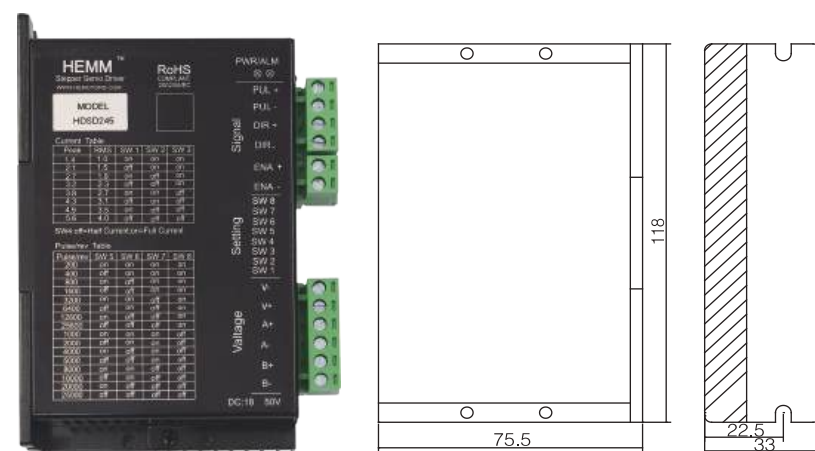

Connection interface:

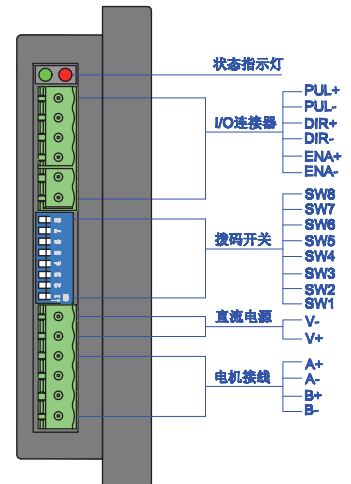

Dimensions (unit: mm):

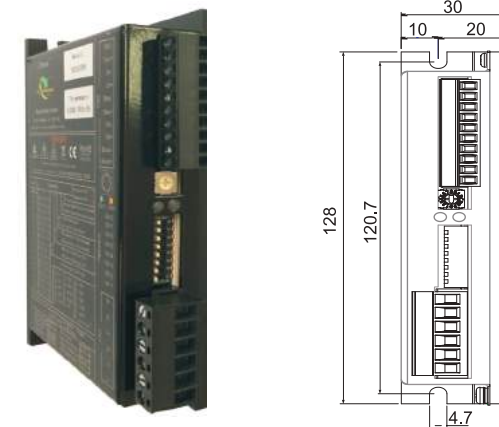

Connection interface:

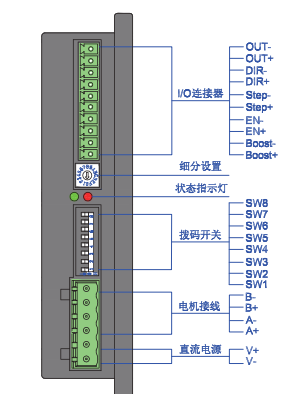

Two phase AC stepper drive HASD252

Features:

- Low noise, low vibration, low heat;
- The output current of the step drive is set by the DIP switch, there are 16 settings, The current virtual value can reach 5A
- Input voltage: 90-240VAC
- Protection: over voltage, under voltage, over current, over temperature;
- Optical isolation signal input/output
- Pulse smoothing function makes motor run more smoothly at low speed and the smoothing level can be set;
- At start-up the drive measure motor parameters, including the resistance and inductance, to optimize system performance.
- Automatic idle current halved to reduce heat after stepping pulse stop moving for 100 millisecond.

Electrical specifications

Parameter	Min	Typical	Max	Unit
Power supply	90	220	240	VAC
Output Current	0.5	-	5	Arms
Input signal voltage	5	-	24	VDC
Current of control signal	-	-	10	mA
Step frequency	0	-	150	KHZ

Dimensions(unit:mm)& Connection interface:

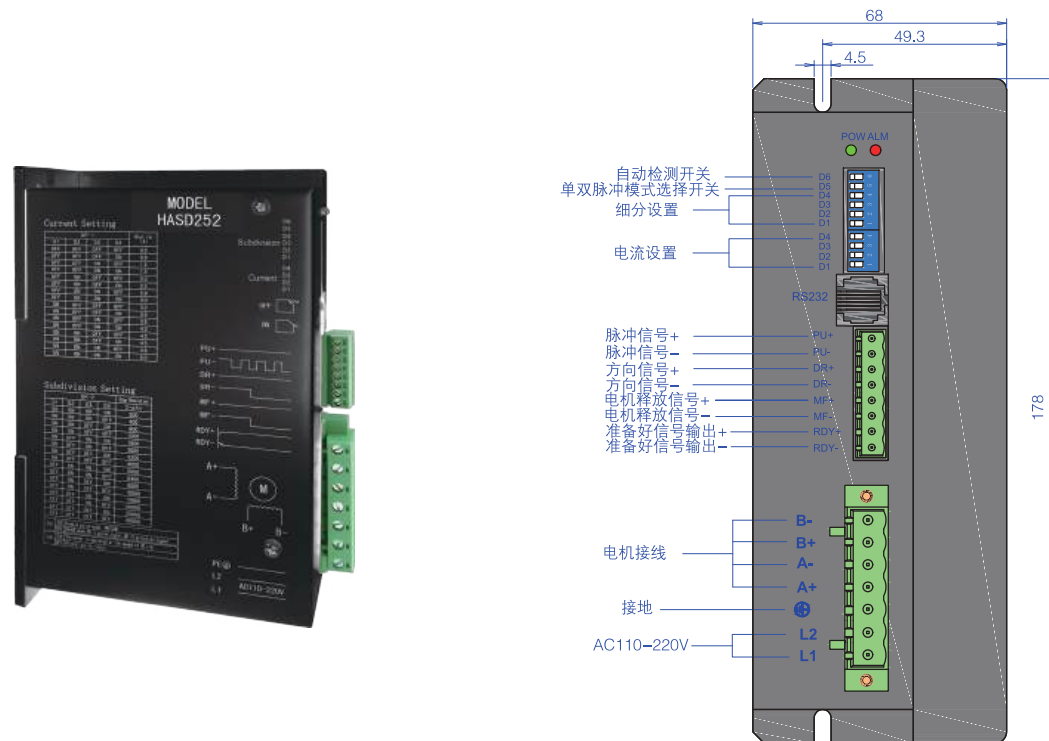

Two phase AC stepper drive HASD272

Features:

- Low noise, low vibration, low heat;
- The output current of the step drive is set by the DIP switch, there are 16 settings, The current virtual value can reach 7A
- Input voltage: 90-240VAC
- Protection: over voltage, under voltage, over current, over temperature;
- Optical isolation signal input/output
- Pulse smoothing function makes motor run more smoothly at low speed and the smoothing level can be set;
- At start-up the drive measure motor parameters, including the resistance and inductance, to optimize system performance.
- Automatic idle current halved to reduce heat after stepping pulse stop moving for 100 millisecond.

Electrical specifications

Parameter	Min	Typical	Max	Unit
Power supply	90	220	240	VAC
Output Current	1.2	-	7	Arms
Input signal voltage	5	-	24	VDC
Current of control signal	-	-	10	mA
Step frequency	0	-	500	KHZ

Dimensions(unit:mm)& Connection interface:

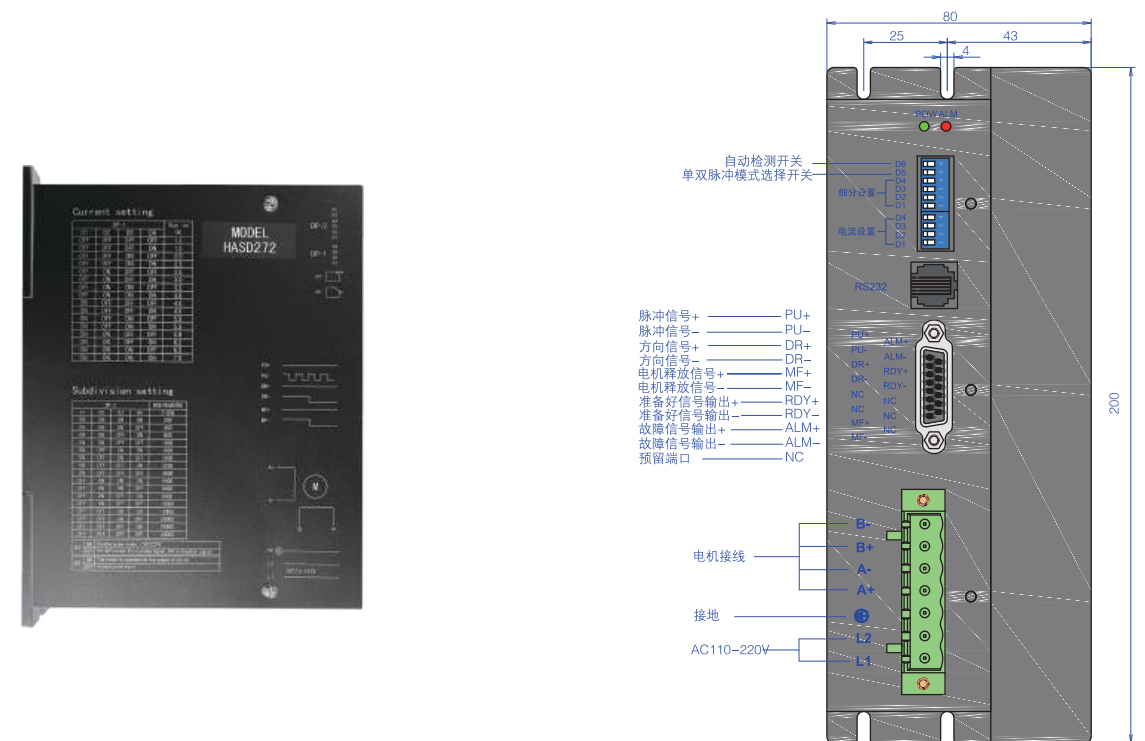

Three phase DC stepper drive HDSD358/HDSD3A8

Features:

- PID current control, low noise, low vibration, low heat;
- The output current of the step drive is set by the DIP switch, there are 16 settings;
- Input voltage: 24-80VDC;
- Protection: over voltage, under voltage, over current, open motor winding;
- Optical isolation signal input/output;
- Automatically calculate the system's natural frequency to improve midrange stability;
- At start-up the drive measure motor parameters, including the resistance and inductance, to optimize system performance.

Three phase AC stepper drive HDSD352/HDSD372

Features:

- Advanced DSP control system, low noise, low vibration, low heat;
- The output current of the step drive is set by the DIP switch, there are 16 settings;the microstep resolution is set by DIP switch, there are 16 settings, Maximum resolution 60000 pulses per revolution;
- Input voltage: 110-240VAC
- Protection: over voltage, under voltage, over current, over temperature;
- Optical isolation signal input/output;
- Motor release function and phase memory function can be set;
- Automatic idle current halved to reduce heat after stepping pulse stop moving for 100 millisecond.

Electrical specifications

Parameter	Min	Typical	Max	Unit
Power supply	24	48	80	VDC
Output Current	HSD348	0.3	4.5	Apeak
	HSD378	2.4	10	
Input signal voltage	5	-	24	VDC
Current of control signal	-	-	10	mA
Step frequency	0	-	500	KHZ

Electrical specifications

Parameter	Min	Typical	Max	Unit
Power supply	110	220	220	VAC
Output Current	HASD352	1.2	5.0	Arms
	HASD372	1.2	7.0	
Input signal voltage	5	-	24	VDC
Current of control signal	-	-	10	mA
Step frequency	0	-	200	KHZ

Dimensions(unit:mm)

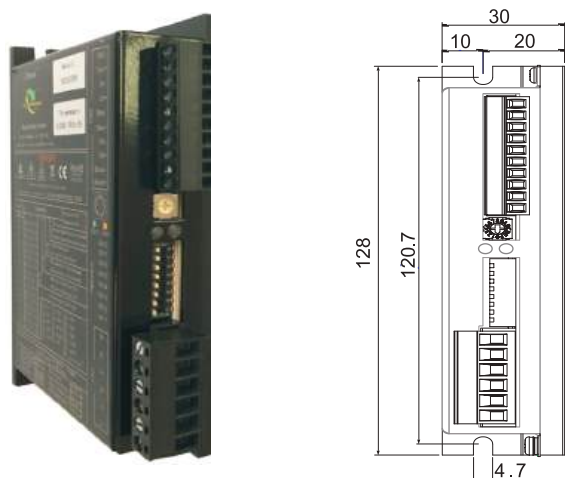

Connection interface:

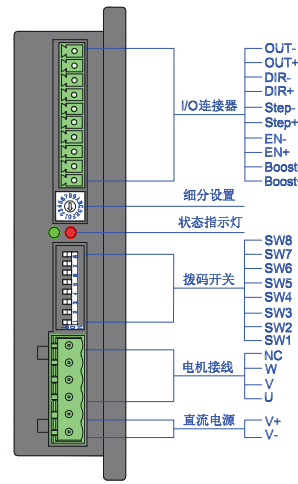

Dimensions(unit:mm)& Connection interface:

HASD352:

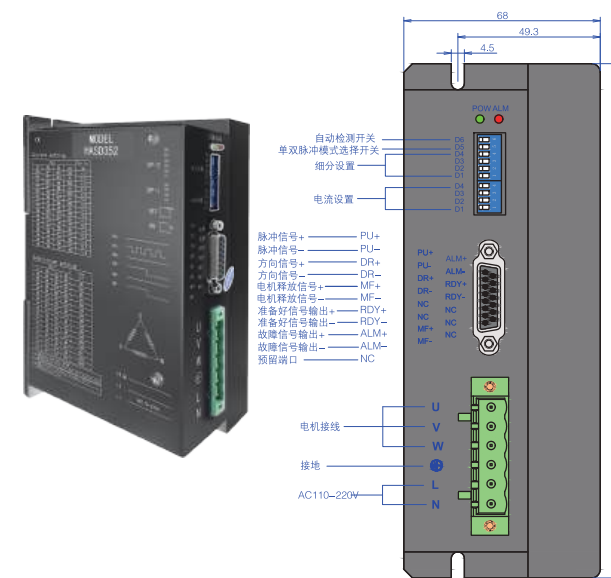

HASD372:

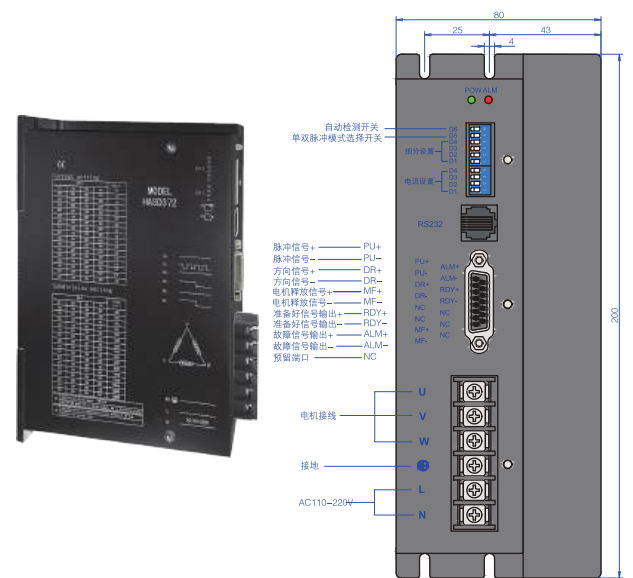

步进驱动器  
STEPPER DRIVE

步进驱动器  
STEPPER DRIVE

2 phase DC

2 phase DC

2 phase AC

2 phase AC

3 phase DC

3 phase DC

3 phase AC

3 phase AC

步进电机  
STEPPER MOTOR

步进电机  
STEPPER MOTOR

2 phase stepper motor

2 phase stepper motor

3 phase stepper motor

3 phase stepper motor

Hercules motor

Hercules motor

Waterproof motor

Waterproof motor

Encoder motor

Encoder motor

Brake motor

Brake motor

Planetary gearbox motor

Planetary gearbox motor

Outdoor anti-rust motor

Outdoor anti-rust motor

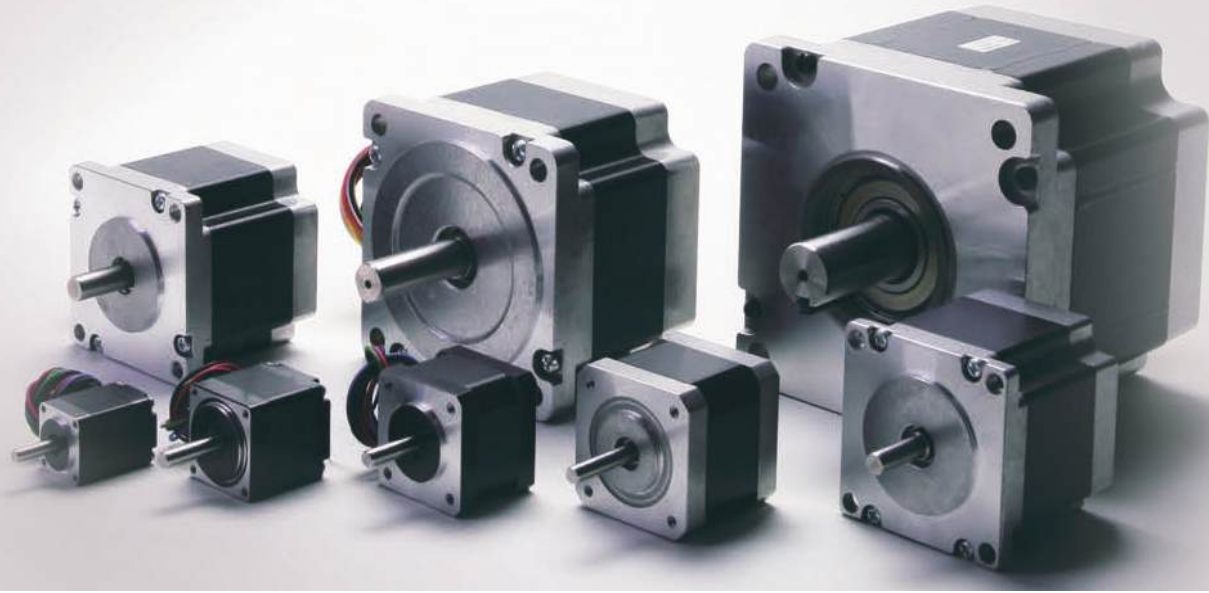

Stepper Motors Naming Rule:

HEM - 23 D 6 8 11 - 01 IP  
 ① ② ③ ④ ⑤ ⑥ ⑦ ⑧

①	②	③	④	⑤	⑥	⑦	⑧
HEMM	NEMA flange	Motor type code	Length	Lead wires number	Performance code	Derivative number	Opition and customeration code
	8 20mm	C Square 2 phase 0.9step			0:Connector typ		IP IP65
	11 28mm	D Square 2 phase 1.8step			3:3		ED Encoder
	14 35mm	T Square 3 phase 1.2step			4:4		PG Plantary gearbox
	16 39mm	F Square 5 phase 0.72step			5:5		BK Brake
	17 42mm	R Round 2 phase 0.9step			6:6		
	23 57mm	S Round 2 phase 1.8 step			8:8		
	24 60mm						
	34 86mm						
	42 110mm						

Stepper motor total parameter table

Phases number	Power type	Step angle	NEMA	Dimension	Model code	Length(mm)	Holding torque (N.m)	Current (A)	Resistance (Ohm)	Rotor inertia (g.cm <sup>2</sup> )	Weight (Kg)	Front axle diameter	Rear axle diameter	Output shaft	
2 phase	DC Power	1.8°	8	□20	HEM-8D2001	27.2	0.017	0.4	7.0	2	0.06	φ4*12	φ4*10	Single	
					HEM-8D2001-01									Double	
				11	□28	HEM-8D4001	37.8	0.030	0.4	11.0	3.6	0.075	φ5*20	φ5*10	Single
						HEM-8D4001-01									Double
				14	○36	HEM-11D2003-02	30.1	0.085	0.7	5.4	9	0.10	φ5*20	φ5*10	Single
						HEM-11D4001									Double
				14	□35	HEM-11D4001-01	39.2	0.115	1.0	2.3	12	0.15	φ5*20	φ5*10	Single
						HEM-11D6001									Double
				14	□35	HEM-11D6001-01	50.4	0.170	1.0	2.5	22	0.22	φ5*20	φ5*15	Single
						HEM-14S04A1									Double
			14	□35	HEM-14S24A1	13.5	0.04	0.3	16.5	7.3	0.04	φ5*20	φ5*15	Single	
					HEM-14S34A1									Double	
			14	□35	HEM-14D1001	16.6	0.10	0.3	18.0	13.5	0.06	φ5*20	φ5*15	Single	
					HEM-14D4001									Double	
			14	□35	HEM-14D4001-01	19.7	0.10	0.4	11.0	19.6	0.10	φ5*20	φ5*15	Single	
					HEM-14D6001									Double	
			14	□35	HEM-17D2012-08	31.4	0.17	1.0	3.2	17	0.16	φ5*20	φ5*15	Single	
					HEM-17D2012-10									Double	
			14	□35	HEM-17D4002-18	42.3	0.26	1.0	3.6	27	0.23	φ5*20	φ5*15	Single	
					HEM-17D4002-20									Double	
			14	□35	HEM-17D6419-03	51.7	0.42	1.0	3.7	40	0.3	φ5*20	φ5*15	Single	
					HEM-17D6419-04									Double	
			14	□35	HEM-17D8403-20	33.7	0.34	1.2	2.4	40	0.21	φ5*20	φ5*15	Single	
					HEM-17D8403-22									Double	
			14	□35	HEM-23D1405-03	39.7	0.44	1.2	3.0	57	0.28	φ5*20	φ5*15	Single	
					HEM-23D1405-05									Double	
			14	□35	HEM-23D4404-18	47.7	0.60	1.8	2.3	82	0.36	φ5*20	φ5*15	Single	
					HEM-23D4404-20									Double	
			14	□35	HEM-23D6406-08	59.7	0.85	1.8	2.8	128	0.61	φ5*20	φ5*15	Single	
					HEM-23D6406-10									Double	
			14	□35	HEM-23D9401-03	42	0.85	3.0	0.55	170	0.42	φ6.35*20.6	φ6.35*15.5	Single	
					HEM-23D9401-06									Double	
			14	□35	HEM-24D2001	53	1.2	4.0	0.39	280	0.55	φ6.35*20.6	φ6.35*15.5	Single	
					HEM-24D5007-01									Double	
			14	□35	HEM-24D7001	77	2.2	4.0	0.50	480	1.0	φ8*20.6	φ8*15.5	Single	
					HEM-24D7001-01									Double	
			14	□35	HEM-34D04A1	112.5	4.0	4.0	1.1	800	1.5	φ8*20.6	φ8*15.5	Single	
					HEM-34D04B1									Double	
			14	□35	HEM-34D24A1	56	1.5	4.0	0.43	280	0.6	φ8*20.6	φ8*15.5	Single	
					HEM-34D24B1									Double	
			14	□35	HEM-34D44A1	87	3.0	4.0	0.60	900	1.4	φ8*20.6	φ8*15.5	Single	
					HEM-34D44B1									Double	
			14	□35	HEM-34D64A1	118	4.8	4.0	1.0	1360	1.9	φ8*20.6	φ8*15.5	Single	
					HEM-34D64B1									Double	
			14	□35	HEM-42D14A1	67.5	4.5	6.0	0.24	950	1.6	φ12.7*37	φ12.7*34	Single	
					HEM-42D14B1									Double	
			14	□35	HEM-42D34A1	96.5	8.5	6.0	0.33	1850	2.7	φ12.7*37	φ12.7*34	Single	
					HEM-42D34B1									Double	
			14	□35	HEM-42D54A1	125.5	11.7	6.0	0.55	2775	3.8	φ14*37	φ14*34	Single	
					HEM-42D54B1									Double	
	14	□35	HEM-42D54B1	158.5	15.2	6.0	0.55	3400	5.7	φ14*37	φ14*34	Single			
			HEM-42D54B1									Double			
	14	□35	HEM-14R04A1	99	9.9	6.0	0.44	5600	5.3	φ19*35	φ19*28	Single			
			HEM-14R24A1									Double			
	14	□35	HEM-14R34A1	149	19.8	6.0	0.66	11000	8.7	φ19*35	φ19*28	Single			
			HEM-17C2001									Double			
	14	□35	HEM-17C2001-01	199	28.3	6.0	0.99	16400	12	φ19*35	φ19*28	Single			
			HEM-17C4001									Double			
	14	□35	HEM-17C4001-01	13.5	0.04	0.3	16.5	7.3	0.06	φ5*20	φ5*15	Single			
			HEM-17C6001									Double			
	14	□35	HEM-17C6001-01	16.6	0.06	0.3	18.0	13.5	0.08	φ5*20	φ5*15	Single			
			HEM-23C1001									Double			
	14	□35	HEM-23C1001-01	19.7	0.10	0.4	11.0	19.6	0.10	φ5*20	φ5*15	Single			
			HEM-23C4002-02									Double			
	14	□35	HEM-23C4002-03	33.7	0.28	1.2	2.4	40	0.21	φ5*20	φ5*15	Single			
			HEM-23C6001-02									Double			
	14	□35	HEM-23C6001-03	39.7	0.34	1.2	3.0	57	0.28	φ5*20	φ5*15	Single			
			HEM-23C6001-03									Double			
	14	□35	HEM-23T13A1	42	0.60	3.0	0.55	170	0.42	φ6.35*20.6	φ6.35*16	Single			
			HEM-23T13B1									Double			
	14	□35	HEM-23T43A1	53	1.10	3.0	0.80	280	0.55	φ6.35*20.6	φ6.35*16	Single			
			HEM-23T43B1									Double			
	14	□35	HEM-23T63A1	77	1.75	3.0	1.15	480	1.0	φ8*20.6	φ8*16	Single			
			HEM-23T63B1									Double			
	14	□35	HEM-24T13A1	42	0.55	5.8	0.34	170	0.42	φ8*20.6	φ8*16	Single			
			HEM-24T13B1									Double			
	14	□35	HEM-24T33A1	53	0.90	5.8	0.42	280	0.8	φ8*20.6	φ8*16	Single			
			HEM-24T33B1									Double			
	14	□35	HEM-24T73A1	83	1.7	5.8	0.70	480	1.25	φ8*20.6	φ8*16	Single			
			HEM-24T73B1									Double			
	14	□35	HEM-34T03A1	67.5	2.5	6.0	0.33	950	1.88	φ12.7*37	φ12.7*34	Single			
			HEM-34T03B1									Double			
	14	□35	HEM-34T23A1	96.5	5.5	6.0	0.50	1850	3.0	φ12.7*37	φ12.7*34	Single			
			HEM-34T23B1									Double			
	14	□35	HEM-34T43A1	125.5	6.8	6.0	0.80	2775	4.25	φ14*37	φ14*34	Single			
			HEM-34T43B1									Double			

STEPPER DRIVE  
步进驱动器

HEM-8D(□20)/11D(□28) 2 phase 1.8°



Parameters:

Model code	Holding torque (N.m)	Current (A)	Resistance (Ohm)	Rotor inertia (g.cm <sup>2</sup> )	Weight (Kg)	Length(mm)	Output shaft
HEM-8D2001	0.017	0.4	7.0	2	0.06	27.2	Single
HEM-8D2001-01							Double
HEM-8D4001	0.030	0.4	11.0	3.6	0.075	37.8	Single
HEM-8D4001-01							Double
HEM-11D2003-02	0.085	0.7	5.4	9	0.10	30.1	Single
HEM-11D2003-05							Double
HEM-11D4001	0.115	1.0	2.3	12	0.15	39.2	Single
HEM-11D4001-01							Double
HEM-11D6001	0.170	1.0	2.5	22	0.22	50.4	Single
HEM-11D6001-01							Double

Dimensions :HEMM-8D

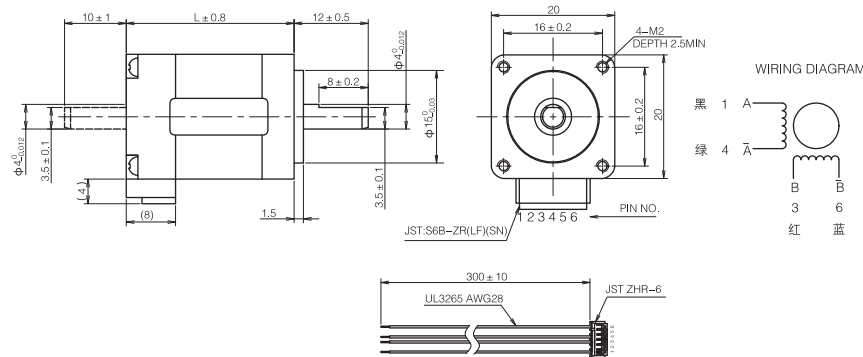

Torque speed curves

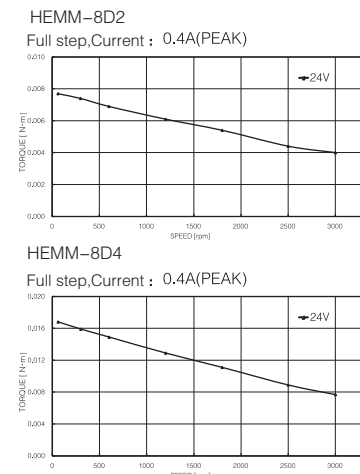

STEPPER DRIVE  
步进驱动器

HEM-14S(Ø36)/14D(□35) 2 phase 1.8°



Parameters:

Model code	Holding torque (N.m)	Current (A)	Resistance (Ohm)	Rotor inertia (g.cm <sup>2</sup> )	Weight (Kg)	Length(mm)	Output shaft
HEM-14S04A1	0.04	0.3	16.5	7.3	0.04	13.5	Single
HEM-14S24A1	0.06	0.3	18.0	13.5	0.06	16.6	Single
HEM-14S34A1	0.10	0.4	11.0	19.6	0.10	19.7	Single
HEM-14D1001	0.17	1.0	3.2	17	0.16	31.4	Single
HEM-14D1001-01							Double
HEM-14D4001	0.26	1.0	3.6	27	0.23	42.3	Single
HEM-14D4001-01							Double
HEM-14D6001	0.42	1.0	3.7	40	0.30	51.7	Single
HEM-14D6001-01							Double

Dimensions :HEM-14S

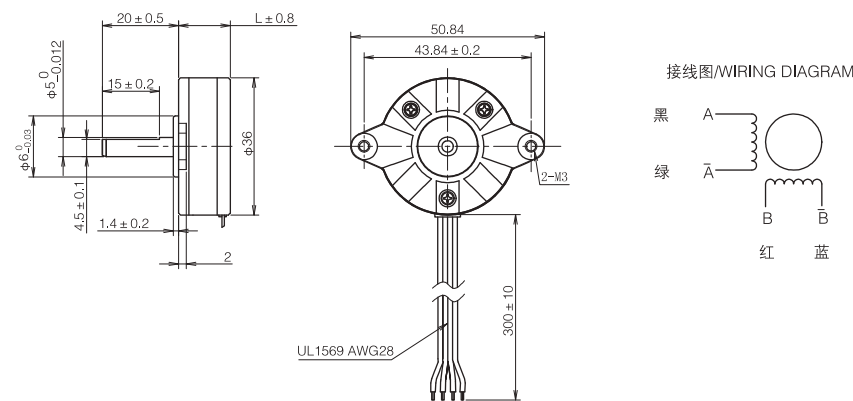

Dimensions :HEM-14D

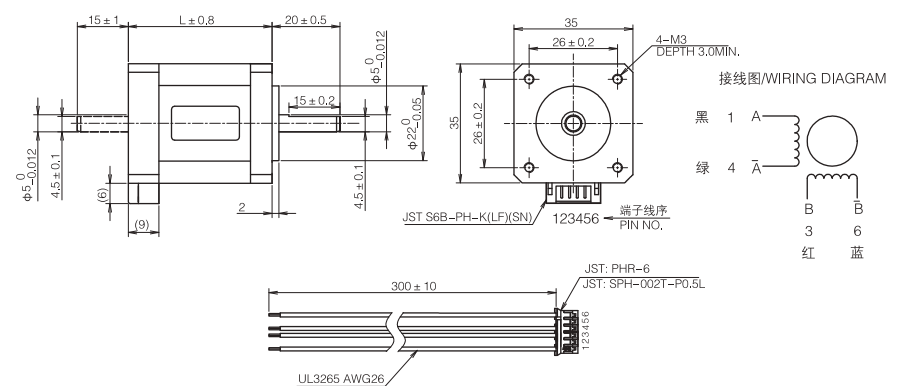

Torque speed curves

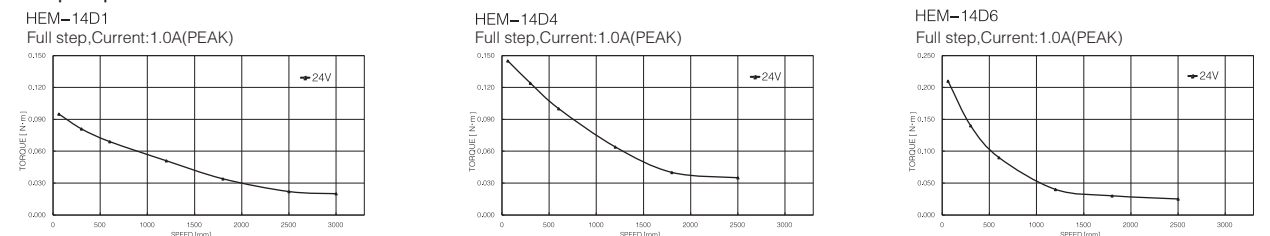

STEPPER MOTOR  
步进电机

STEPPER MOTOR  
步进电机

Dimensions :HEMM-11D

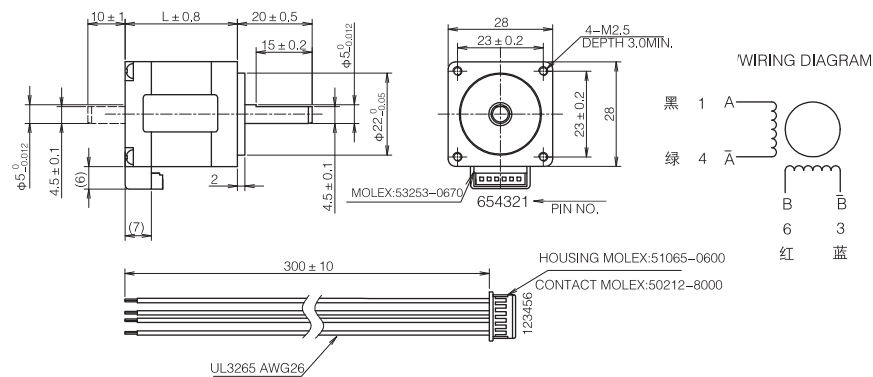

Torque speed curves

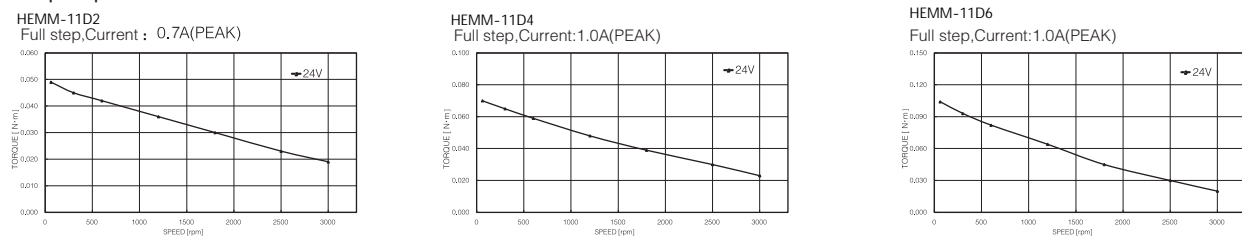

2 phase stepper motor

3 phase stepper motor

Hercules motor

Waterproof motor

Encoder motor

Brake motor

Planetary gearbox motor

Outdoor anti-rust motor

2 phase stepper motor

3 phase stepper motor

Hercules motor

Waterproof motor

Encoder motor

Brake motor

Planetary gearbox motor

Outdoor anti-rust motor

STEPPER DRIVE  
步进驱动器

HEM-17D(□42) 2phase 1.8°



Parameters:

Model code	Holding torque (N.m)	Current (A)	Resistance (Ohm)	Rotor inertia (g.cm <sup>2</sup> )	Weight (kg)	Length(mm)	Output shaft
HEM-17D2012-08	0.34	1.2	2.4	40	0.21	33.7	Single
HEM-17D2012-10							Double
HEM-17D4002-18	0.44	1.2	3.0	57	0.28	39.7	Single
HEM-17D4002-20							Double
HEM-17D6419-03	0.60	1.8	2.3	82	0.36	47.7	Single
HEM-17D6419-04							Double
HEM-17D8403-20	0.85	1.8	2.8	128	0.61	59.7	Single
HEM-17D8403-22							Double

Dimensions :HEM-17D

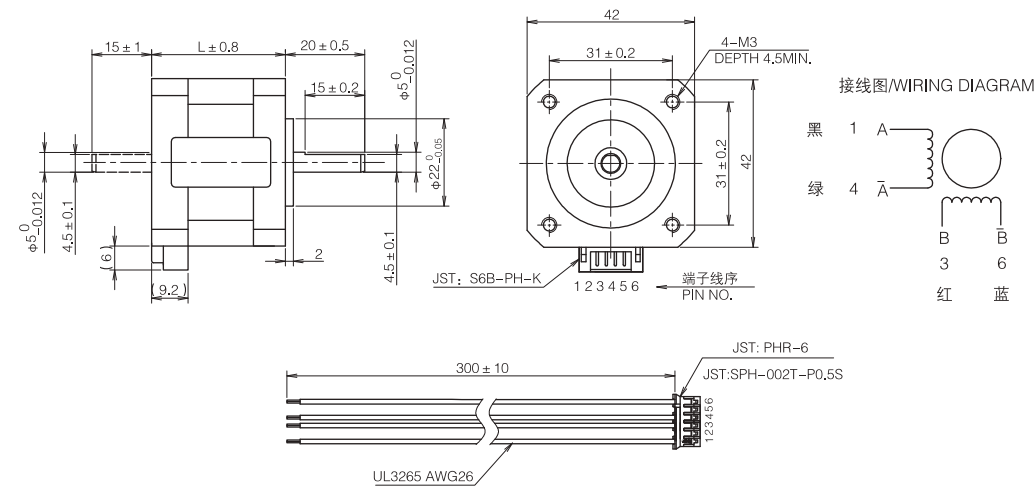

Torque speed curves

HEM-17D2  
Full step,Current:1.2A(PEAK)

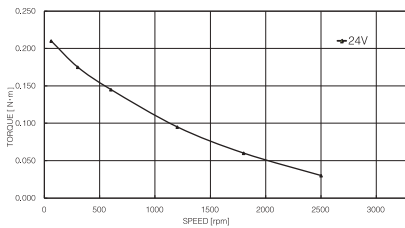

HEM-17D4  
Full step,Current:1.2A(PEAK)

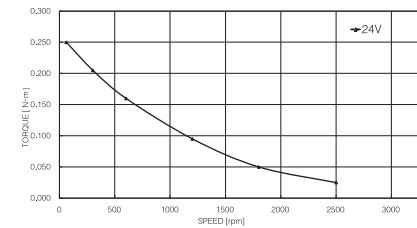

HEM-17D6  
Full step,Current:1.8A(PEAK)

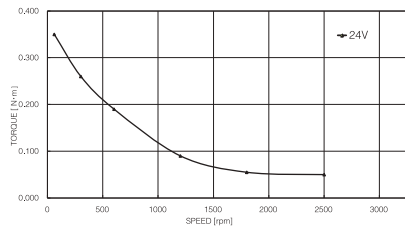

HEM-17D8  
Full step,Current:1.8A(PEAK)

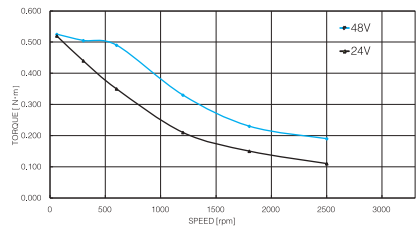

HEM-23D(□57) 2phase 1.8°



Parameters:

Model code	Holding torque (N.m)	Current (A)	Resistance (Ohm)	Rotor inertia (g.cm <sup>2</sup> )	Weight (Kg)	Length(mm)	Output shaft
HEM-23D1405-03	0.85	3.0	0.55	170	0.42	42	Single
HEM-23D1405-05							Double
HEM-23D4404-18	1.2	4.0	0.39	280	0.55	53	Single
HEM-23D4404-20							Double
HEM-23D6406-08	2.2	4.0	0.50	480	1.0	77	Single
HEM-23D6406-10							Double
HEM-23D9401-03	4.0	4.0	1.1	800	1.5	112.5	Single
HEM-23D9401-06							Double

Dimensions :HEM-23D

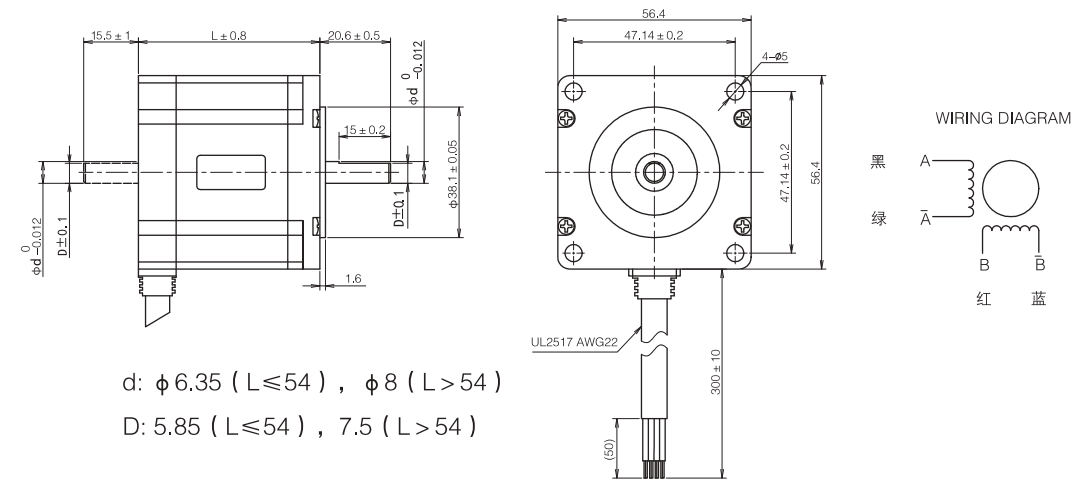

Torque speed curves

HEMM-23D4

HEMM-23D1  
Full step,Current:3.0A(PEAK)

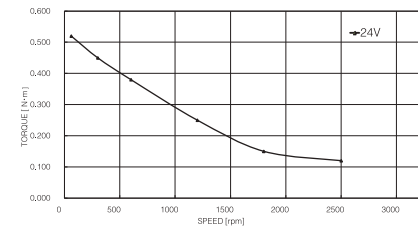

HEMM-23D6

Full step,Current:4.0A(PEAK)

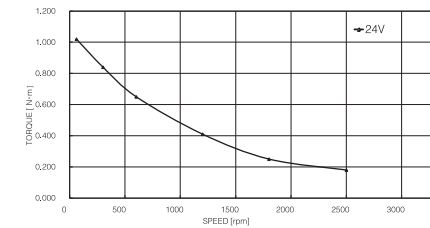

HEMM-23D8

Full step,Current:4.0A(PEAK)

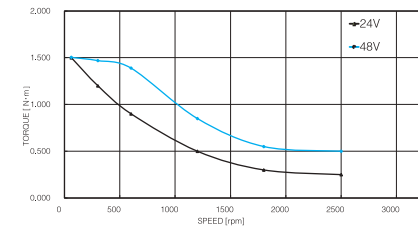

Full step,Current:4.0A(PEAK)

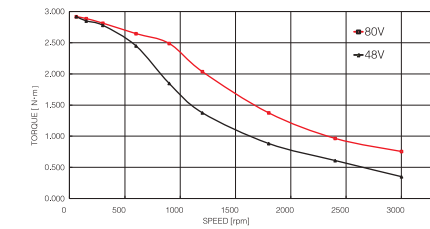

STEPPER MOTOR  
步进电机

STEPPER DRIVE  
步进驱动器

2 phase DC

2 phase AC

3 phase DC

3 phase AC

STEPPER MOTOR  
步进电机

2 phase stepper motor

3 phase stepper motor

Hercules motor

Waterproof motor

Encoder motor

Brake motor

Planetary gearbox motor

Outdoor anti-rust motor

步进驱动器  
STEPPER DRIVE

HEM-24D(□60) 2phase 1.8°



Parameters:

Model code	Holding torque (N.m)	Current (A)	Resistance (Ohm)	Rotor inertia (g.cm <sup>2</sup> )	Weight (Kg)	Length(mm)	Output shaft
HEM-24D2001	1.5	4.0	0.43	280	0.6	56	单
HEM-24D2001-02							双
HEM-24D5007	3.0	4.0	0.60	900	1.4	87	单
HEM-24D5007-01							双
HEM-24D7001	4.8	4.0	1.0	1360	1.9	118	单
HEM-24D7001-01							双

Single  
Double  
Single  
Double  
Single  
Double

Dimensions :HEM-24D

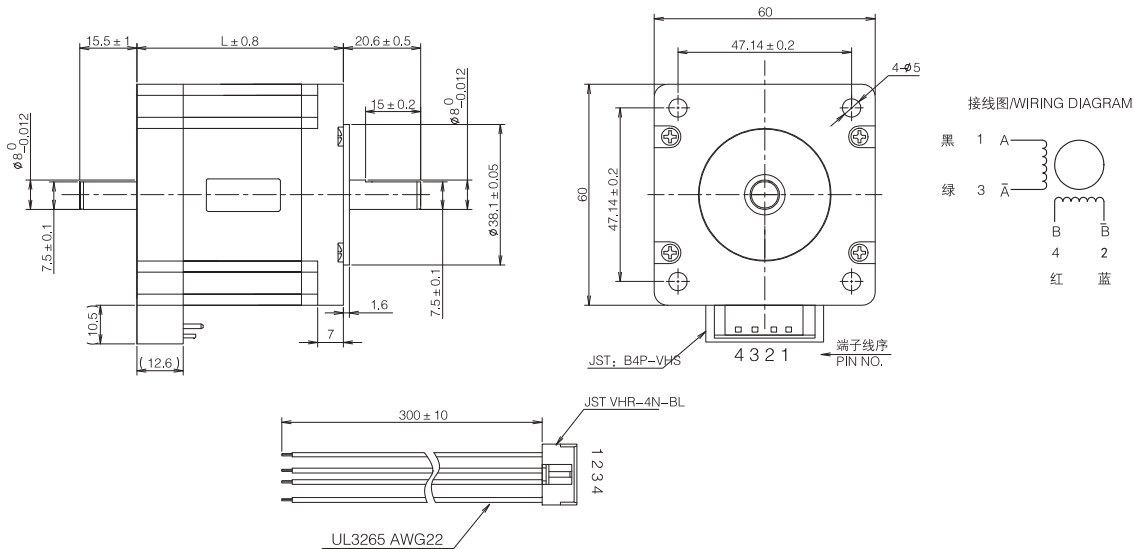

2 phase DC

2 phase AC

3 phase DC

3 phase AC

步进电机  
STEPPER MOTOR

2 phase stepper motor

3 phase stepper motor

Hercules motor

Waterproof motor

Encoder motor

Brake motor

Planetary gearbox motor

Outdoor anti-rust motor

Torque speed curves

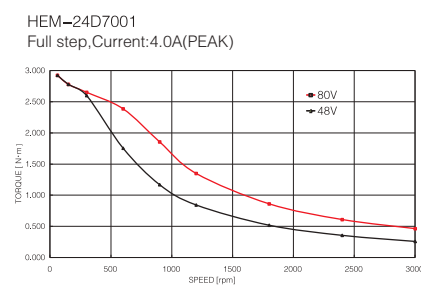
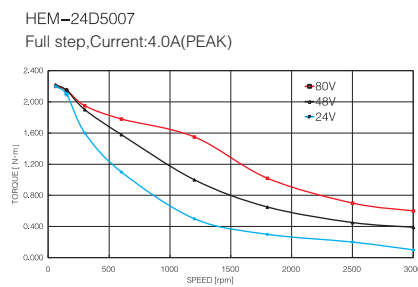
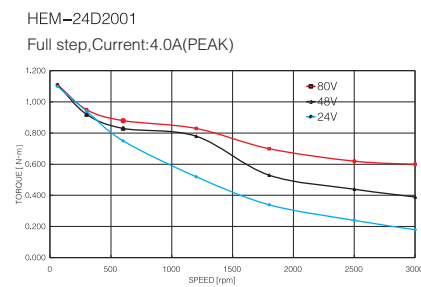

HEM-34D(□86) 2phase 1.8°



Parameters:

Model code	Holding torque (N.m)	Current (A)	Resistance (Ohm)	Rotor inertia (g.cm <sup>2</sup> )	Weight (Kg)	Length(mm)	Output shaft
HEM-34D04A1	4.5	6.0	0.24	950	1.6	67.5	Single
HEM-34D04B1							Double
HEM-34D24A1	8.5	6.0	0.33	1850	2.7	96.5	Single
HEM-34D24B1							Double
HEM-34D44A1	11.7	6.0	0.55	2775	3.8	125.5	Single
HEM-34D44B1							Double
HEM-34D64A1	15.2	6.0	0.55	3400	5.7	158.5	Single
HEM-34D64B1							Double

Dimensions :HEM-34D

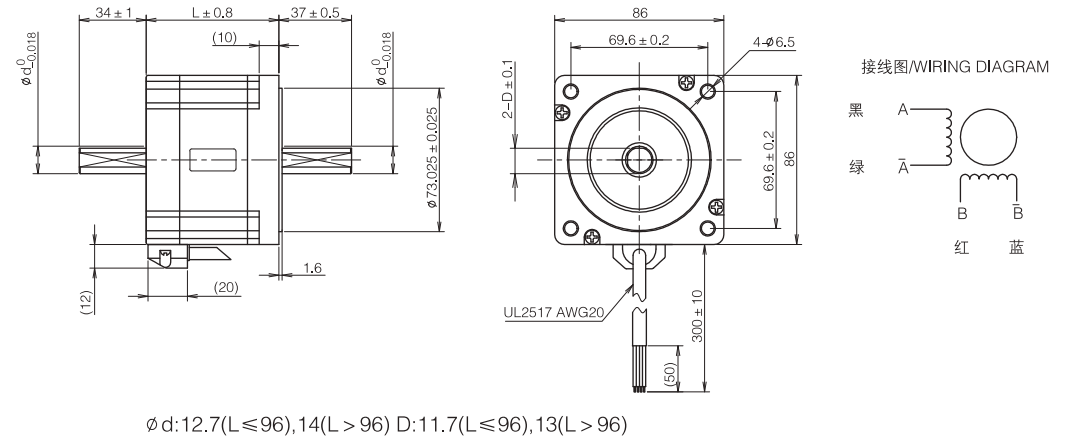

φ d: 12.7(L≤96), 14(L > 96) D: 11.7(L≤96), 13(L > 96)

Torque speed curves

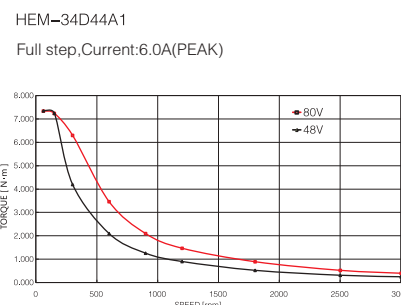
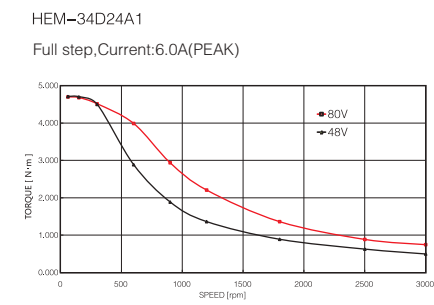
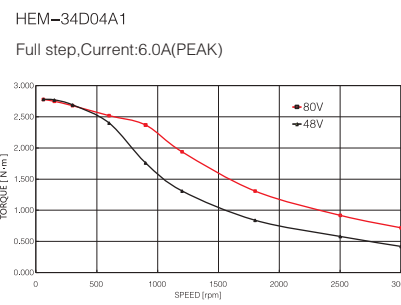

步进驱动器  
STEPPER DRIVE

2 phase DC

2 phase AC

3 phase DC

3 phase AC

步进电机  
STEPPER MOTOR

2 phase stepper motor

3 phase stepper motor

Hercules motor

Waterproof motor

Encoder motor

Brake motor

Planetary gearbox motor

Outdoor anti-rust motor

步进驱动器  
STEPPER DRIVE

HEM-42D(□110) 2 phase 1.8°



Parameters:

Model code	Holding torque (N.m)	Current (A)	Resistance (Ohm)	Rotor inertia (g.cm <sup>2</sup> )	Weight (Kg)	Length(mm)	Output shaft
HEM-42D14A1	9.9	6.0	0.44	5600	5.3	99	Single
HEM-42D14B1							Double
HEM-42D34A1	19.8	6.0	0.66	11000	8.7	149	Single
HEM-42D34B1							Double
HEM-42D54A1	28.3	6.0	0.99	16400	12	199	Single
HEM-42D54B1							Double

Dimensions :HEM-42D

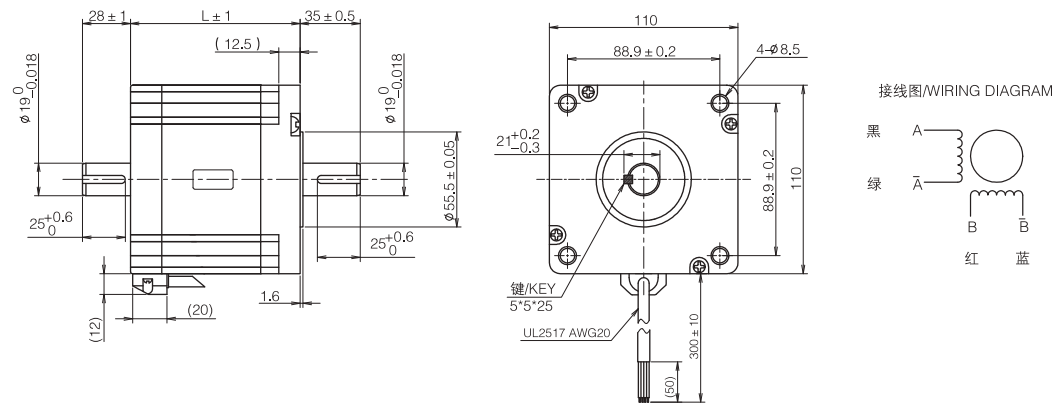

2 phase DC

2 phase AC

3 phase DC

3 phase AC

步进电机  
STEPPER MOTOR

2 phase stepper motor

3 phase stepper motor

Hercules motor

Waterproof motor

Encoder motor

Brake motor

Planetary gearbox motor

Outdoor anti-rust motor

HEM-14R(Ø36) 2phase 0.9°



Parameters:

Model code	Holding torque (N.m)	Current (A)	Resistance (Ohm)	Rotor inertia (g.cm <sup>2</sup> )	Weight (Kg)	Length(mm)	Output shaft
HEM-14R04A1	0.04	0.3	16.5	7.3	0.06	13.5	Single
HEM-14R24A1	0.06	0.3	18.0	13.5	0.08	16.6	Single
HEM-14R34A1	0.10	0.4	11.0	19.6	0.10	19.7	Single

Dimensions :HEM-14R

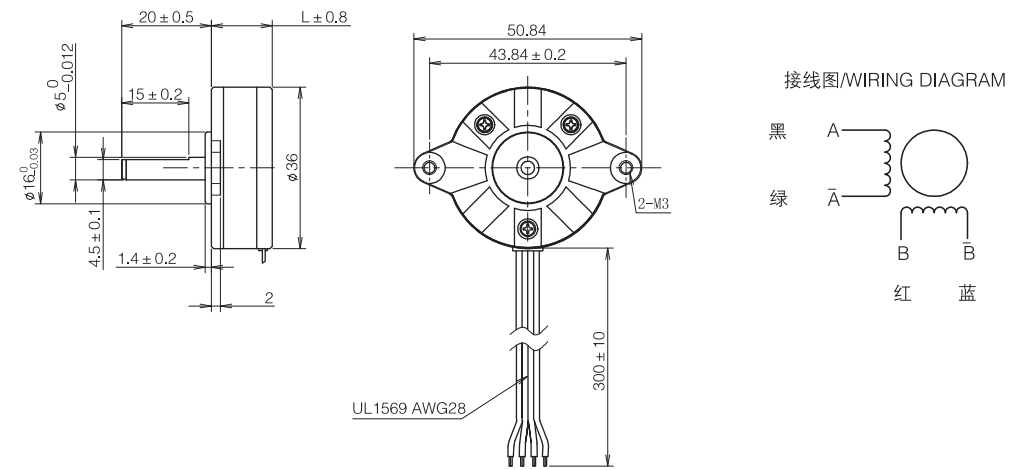

步进驱动器  
STEPPER DRIVE

2 phase DC

2 phase AC

3 phase DC

3 phase AC

步进电机  
STEPPER MOTOR

2 phase stepper motor

3 phase stepper motor

Hercules motor

Waterproof motor

Encoder motor

Brake motor

Planetary gearbox motor

Outdoor anti-rust motor

步进驱动器  
STEPPER DRIVE

HEM-17C(□42)/23C(□57) 2phase 0.9°



Parameters:

Model code	Holding torque (N.m)	Current (A)	Resistance (Ohm)	Rotor inertia (g.cm <sup>2</sup> )	Weight (Kg)	Length(mm)	Output shaft
HEM-17C2001	0.28	1.2	2.4	40	0.21	33.7	Single
HEM-17C2001-01							Double
HEM-17C4001	0.34	1.2	3.0	57	0.28	39.7	Single
HEM-17C4001-01							Double
HEM-17C6001	0.49	1.2	3.2	82	0.36	47.7	Single
HEM-17C6001-01							Double
HEM-23C1001	0.60	3.0	0.55	170	0.42	42	Single
HEM-23C1001-01							Double
HEM-23C4002-02	1.10	3.0	0.80	280	0.55	53	Single
HEM-23C4002-03							Double
HEM-23C6001-02	1.75	3.0	1.15	480	1.0	77	Single
HEM-23C6001-03							Double

Dimensions :HEM-17C

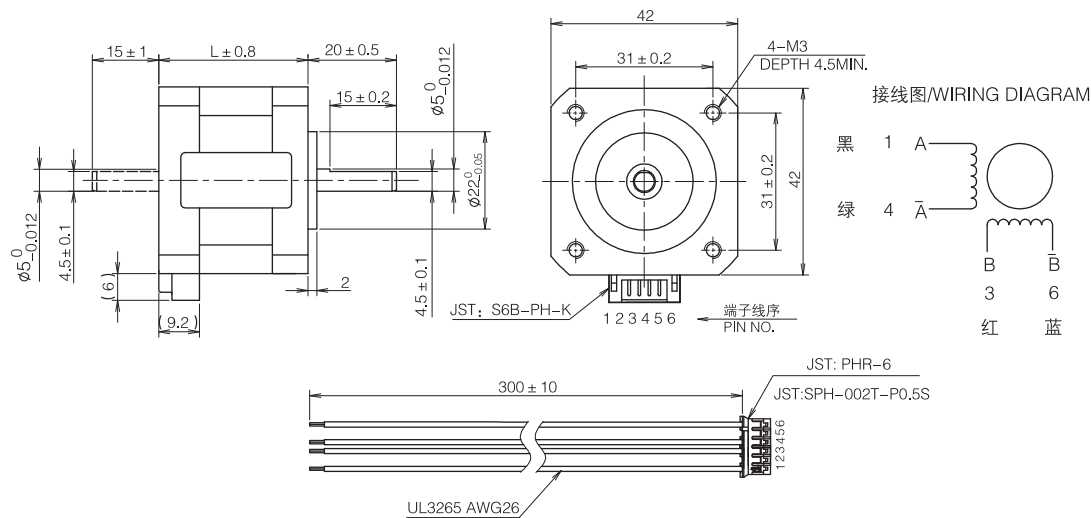

Dimensions :HEM-23C

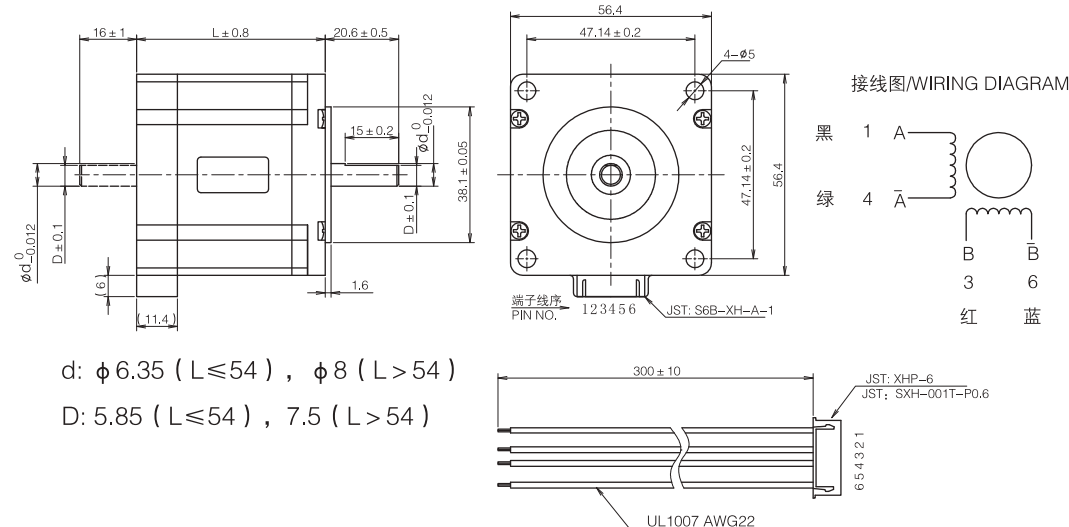

HEM-17T(□42) 3phase 1.2°



Parameters:

Model code	Holding torque (N.m)	Current (A)	Resistance (Ohm)	Rotor inertia (g.cm <sup>2</sup> )	Weight (Kg)	Length(mm)	Output shaft
HEM-17T23A1	0.24	2.5	1.3	40	0.21	33.7	Single
HEM-17T23B1							Double
HEM-17T43A1	0.34	2.5	1.5	57	0.28	39.7	Single
HEM-17T43B1							Double
HEM-17T63A1	0.45	2.5	1.9	82	0.36	47.7	Single
HEM-17T63B1							Double

Dimensions :HEM-17T

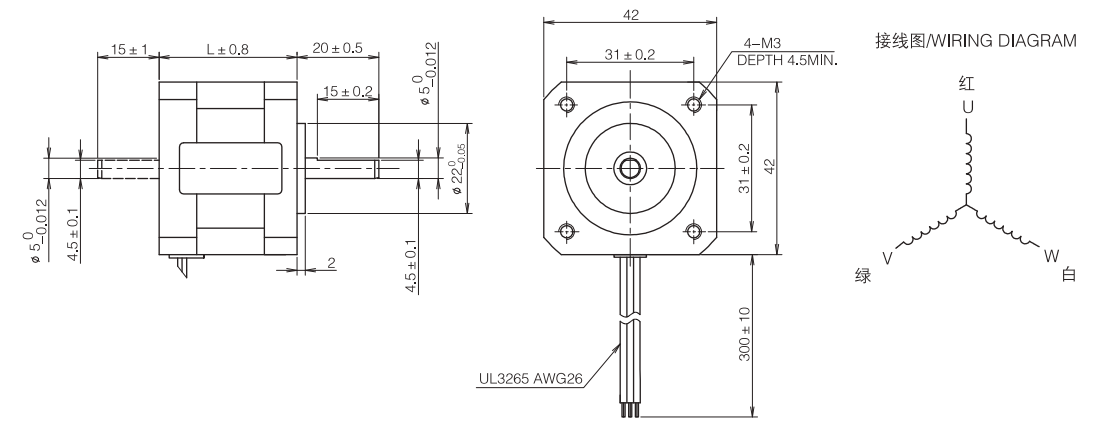

HEM-23T(□57) 3phase 1.2°



Parameters:

Model code	Holding torque (N.m)	Current (A)	Resistance (Ohm)	Rotor inertia (g.cm <sup>2</sup> )	Weight (Kg)	Length(mm)	Output shaft
HEM-23T13A1	0.5	5.8	0.34	170	0.42	42	Single
HEM-23T13B1							Double
HEM-23T43A1	0.8	5.8	0.45	280	0.55	53	Single
HEM-23T43B1							Double
HEM-23T63A1	1.5	5.8	0.50	480	1.0	77	Single
HEM-23T63B1							Double

Dimensions :HEM-23T

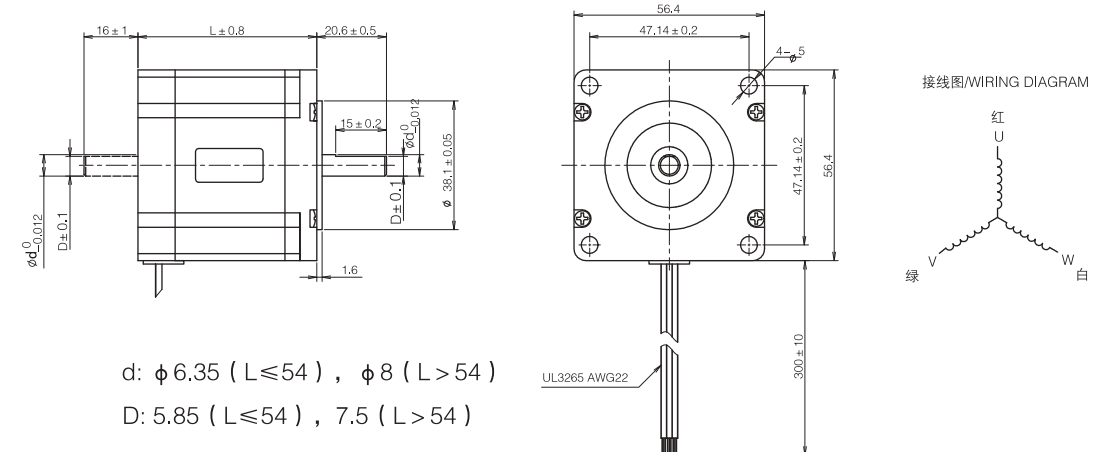

d:  $\phi 6.35$  ( $L \leq 54$ ),  $\phi 8$  ( $L > 54$ )  
D: 5.85 ( $L \leq 54$ ), 7.5 ( $L > 54$ )

步进电机  
STEPPER MOTOR

步进驱动器  
STEPPER DRIVE

2 phase DC

2 phase AC

3 phase DC

3 phase AC

步进电机  
STEPPER MOTOR

2 phase stepper motor

3 phase stepper motor

Hercules motor

Waterproof motor

Encoder motor

Brake motor

Planetary gearbox motor

Outdoor anti-rust motor

2 phase stepper motor

3 phase stepper motor

Hercules motor

Waterproof motor

Encoder motor

Brake motor

Planetary gearbox motor

Outdoor anti-rust motor

步进驱动器  
STEPPER DRIVE

HEM-24T(□60) 3 phase 1.2°



Parameters:

Model code	Holding torque (N.m)	Current (A)	Resistance (Ohm)	Rotor inertia (g.cm <sup>2</sup> )	Weight (kg)	Length(mm)	Output shaft
HEM-24T13A1	0.55	5.8	0.35	170	0.42	42	Single
HEM-24T13B1							Double
HEM-24T33A1	0.90	5.8	0.42	280	0.8	53	Single
HEM-24T33B1							Double
HEM-24T73A1	1.7	5.8	0.70	480	1.25	83	Single
HEM-24T73B1							Double

Dimensions :HEM-24T

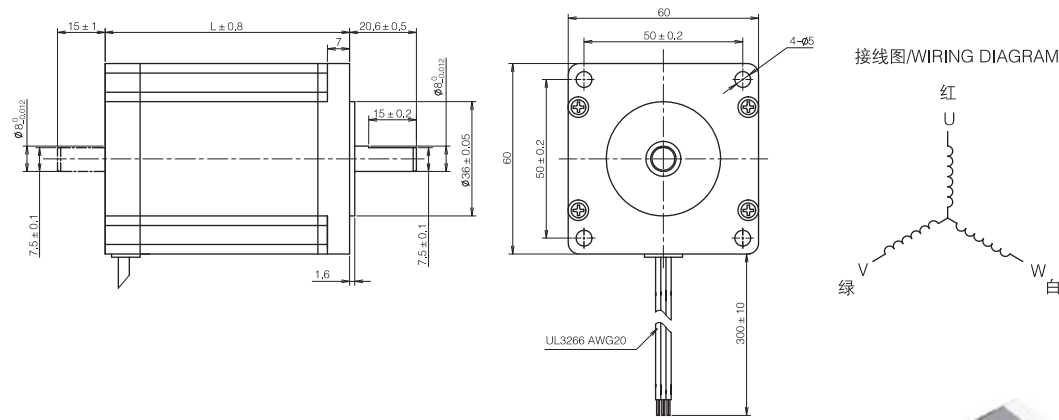

2 phase DC

2 phase AC

3 phase DC

3 phase AC

步进电机  
STEPPER MOTOR

HEM-34T(□86) 3 phase 1.2°



Parameters:

Model code	Holding torque (N.m)	Current (A)	Resistance (Ohm)	Rotor inertia (g.cm <sup>2</sup> )	Weight (kg)	Length(mm)	Output shaft
HEM-34T03A1	2.5	6.0	0.33	950	1.88	67.5	Single
HEM-34T03B1							Double
HEM-34T23A1	5.5	6.0	0.50	1850	3.0	96.5	Single
HEM-34T23B1							Double
HEM-34T43A1	6.8	6.0	0.80	2775	4.25	125.5	Single
HEM-34T43B1							Double

Dimensions :HEM-34T

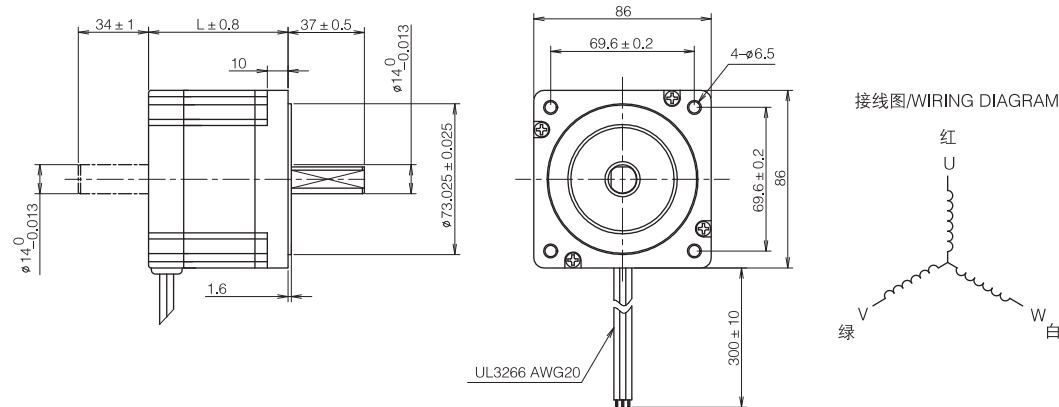

2 phase stepper motor

3 phase stepper motor

Hercules motor

Waterproof motor

Encoder motor

Brake motor

Planetary gearbox motor

Outdoor anti-rust motor

HEM-23H(□57) /34H(□86) Hercules motor 2 phase 1.8°



Advantage: The same volume, Torque increases by 20%-30%  
Patented products  
Easy to manipulate

Parameters:

Model code	Holding torque (N.m)	Current (A)	Resistance (Ohm)	Rotor inertia (g.cm <sup>2</sup> )	Weight (kg)	Length(mm)	Output shaft
HEM-23H4406	1.6	3.0	0.72	280	0.65	53	Single
HEM-34H0402	4.2	6.0	0.3	950	2.0	67.5	Single

Torque speed curves

Hercules motor(HEM-23H4406)

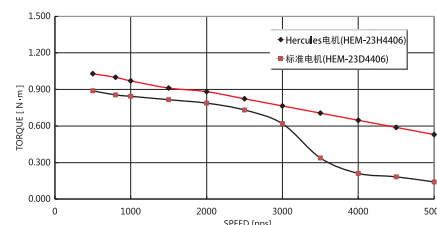

Hercules motor(HEM-34H0402)

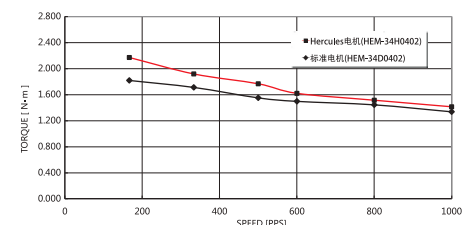

Dimensions :HEM-23H4406

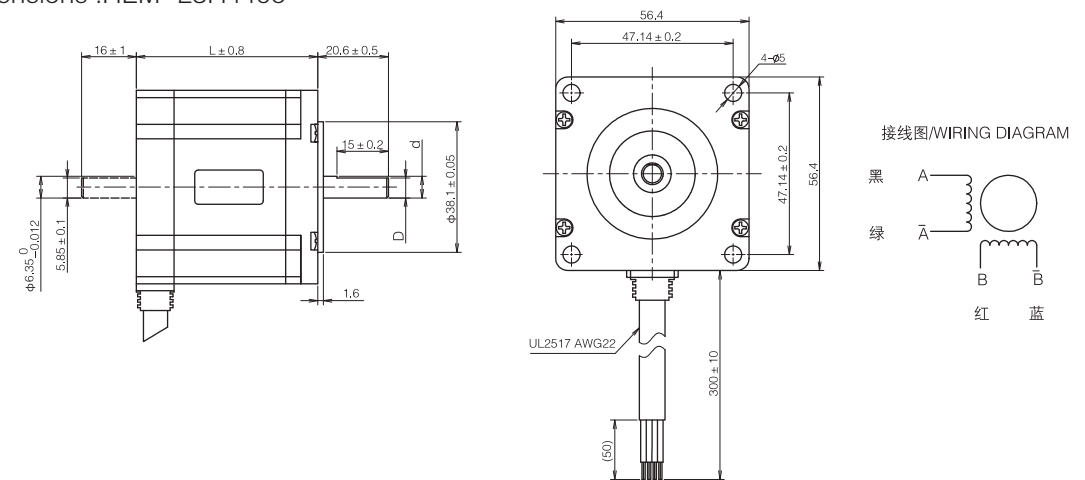

Dimensions :HEM-34H0402

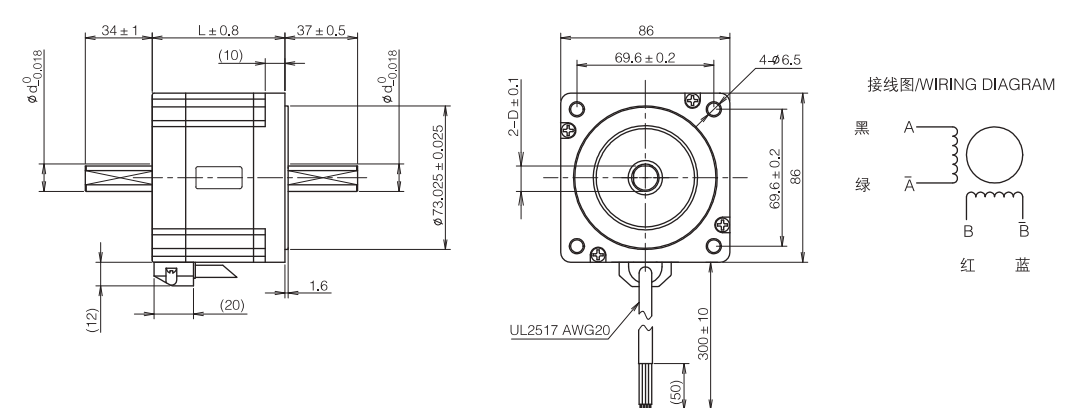

步进驱动器  
STEPPER DRIVE

2 phase DC

2 phase AC

3 phase DC

3 phase AC

步进电机  
STEPPER MOTOR

2 phase stepper motor

3 phase stepper motor

Hercules motor

Waterproof motor

Encoder motor

Brake motor

Planetary gearbox motor

Outdoor anti-rust motor

步进驱动器  
STEPPER DRIVE

HEM-17D(□42)/23D(□57)/24D(□60)/34D(□86)/42D(□110) IP65 waterproof motor 2 phase 1.8°

Parameters:

Model code	Holding torque (N.m)	Current (A)	Resistance (Ohm)	Rotor inertia (g.cm <sup>2</sup> )	Weight (Kg)	Length(mm)	Output shaft
HEM-17D4402-43IP	0.35	1.3	3.0	57	0.32	46.5	-
HEM-23D4404-29IP	1.1	4.0	0.5	280	0.79	70.0	-
HEM-23D6410-40IP	2.0	4.0	0.6	480	1.25	94.0	-
HEM-24D5405-12IP	2.7	3.0	1.3	810	1.75	117.5	-
HEM-34D1408-03IP	5.4	6.0	0.2	1400	2.8	113.5	-
HEM-34D3405-07IP	8.5	6.0	0.4	2500	4.5	152.5	-
HEM-42D3403-01IP	20.5	4.2	2.0	10900	9.4	182.0	-

Dimensions :HEM-17D4402-43IP

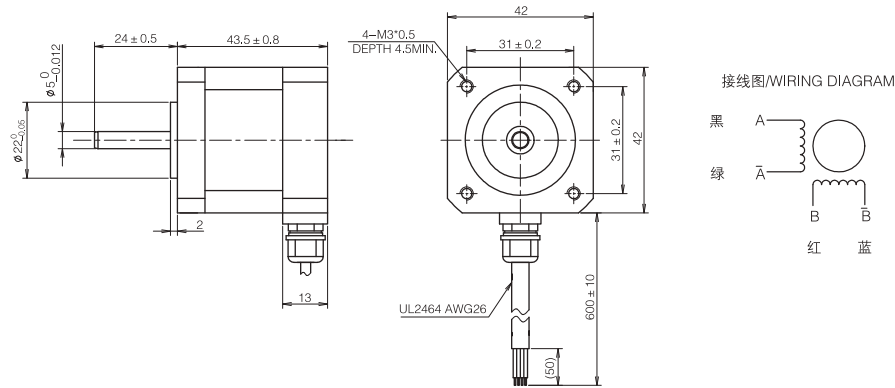

Dimensions :HEM-23D4404-29IP

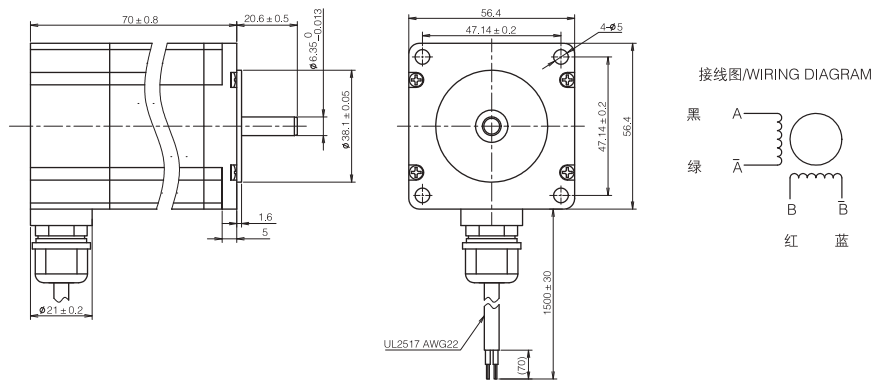

Dimensions :HEM-23D6410-40IP

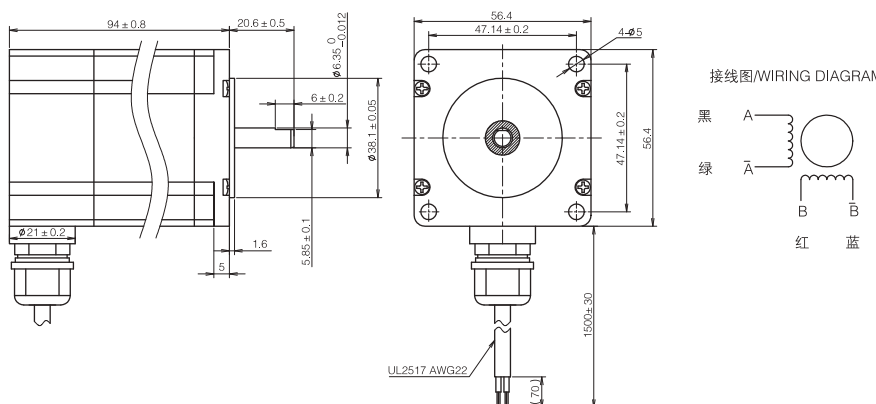

Dimensions :HEM-24D5405-12IP

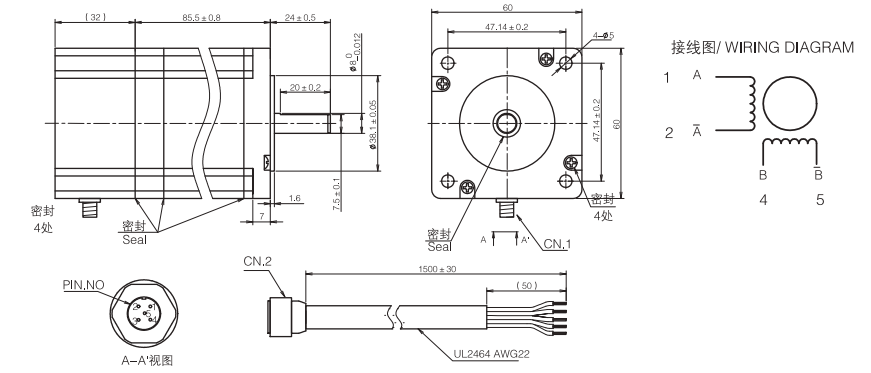

Dimensions :HEM-34D1408-03IP

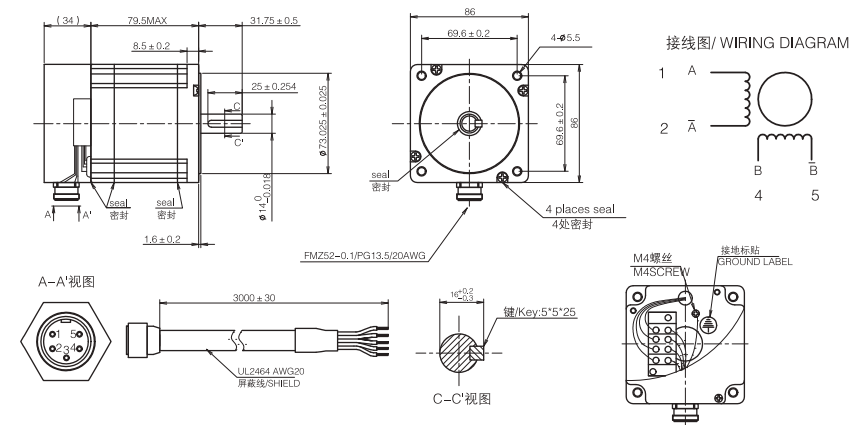

Dimensions :HEM-34D3405-07IP

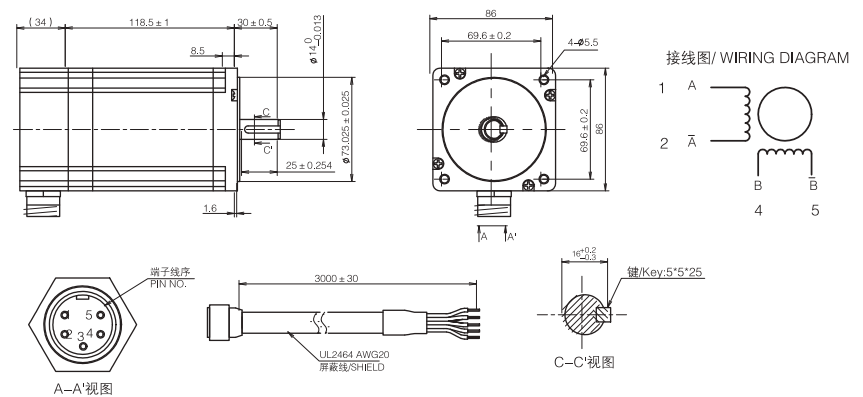

Dimensions :HEM-42D3403-01IP

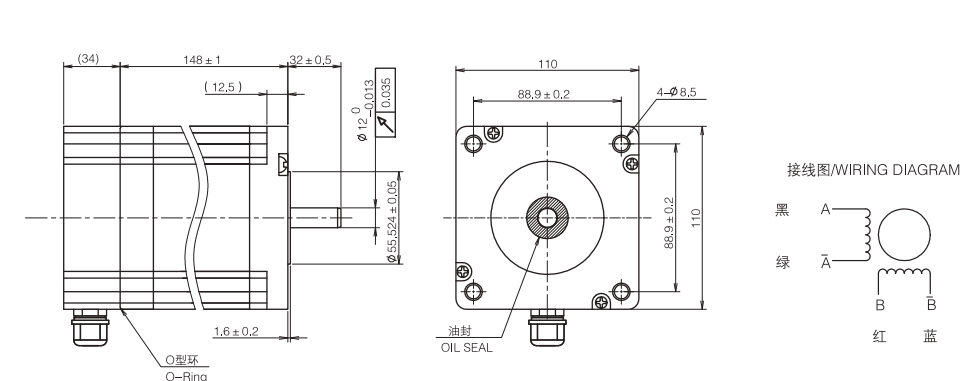

2 phase DC

2 phase AC

3 phase DC

3 phase AC

步进电机  
STEPPER MOTOR

2 phase stepper motor

3 phase stepper motor

Hercules motor

Waterproof motor

Encoder motor

Brake motor

Planetary gearbox motor

Outdoor anti-rust motor

步进驱动器  
STEPPER DRIVE

2 phase DC

2 phase AC

3 phase DC

3 phase AC

步进电机  
STEPPER MOTOR

2 phase stepper motor

3 phase stepper motor

Hercules motor

Waterproof motor

Encoder motor

Brake motor

Planetary gearbox motor

Outdoor anti-rust motor



步进驱动器  
STEPPER DRIVE

HEM-24D(□60)/34D(□86) Encoder motor

Parameters:

Model code	Holding torque (N.m)	Current (A)	Resistance (Ohm)	Resolution	Rotor inertia (g.cm <sup>2</sup> )	Weight(Kg)	Length(mm)
HEM-24D5007-03ED	3.0	4.2	0.6	1000	900	1.3	107
HEM-34D0402-19ED	3.0	6.0	0.3	1000	2775	1.85	91
HEM-34D2407-36ED	5.8	6.0	0.4	1000	2775	3.1	120
HEM-34D4401-16ED	8.7	6.0	0.6	1000	2775	4.2	150

Dimensions :HEM-24D series

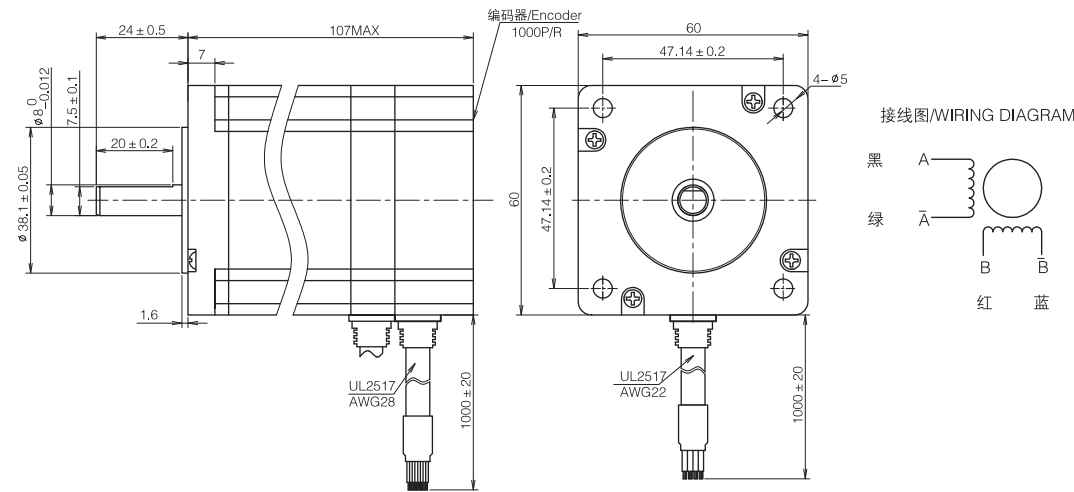

2 phase DC

2 phase AC

3 phase DC

3 phase AC

步进电机  
STEPPER MOTOR

2 phase stepper motor

3 phase stepper motor

Hercules motor

Waterproof motor

Encoder motor

Brake motor

Planetary gearbox motor

Outdoor anti-rust motor

步进驱动器  
STEPPER DRIVE

HEM-17D(□42)/23D(□57) Brake motor

Parameters:

Model code	Brake specifications		Holding torque (N.m)	Current (A)	Resistance (Ohm)	Rotor inertia (g.cm <sup>2</sup> )	Weight (Kg)	Length(mm)
	Power(DC)	Torque(N.m)						
HEM-17D4402-34BK	24V	0.36	0.45	1.2	3.0	57	0.48	71.8
HEM-17D8402-10BK	24V	0.36	0.90	2.5	1.4	128	0.81	91.8
HEM-23D4404-21BK	24V	1.5	1.2	4.0	0.4	280	0.95	85
HEM-23D6406-11BK	24V	1.5	2.2	4.0	0.5	480	1.4	109
HEM-23D9401-07BK	24V	1.5	3.0	4.0	1.1	800	1.9	145

Dimensions :HEM-17D series

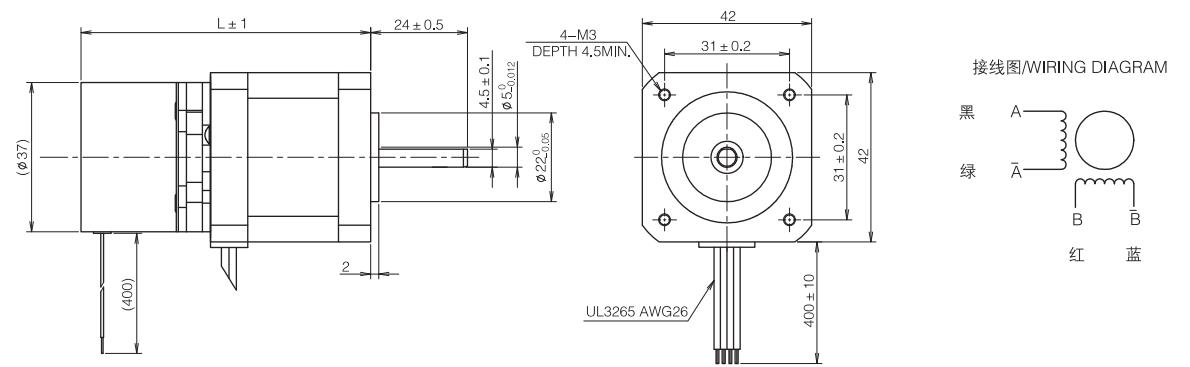

2 phase DC

2 phase AC

3 phase DC

3 phase AC

步进电机  
STEPPER MOTOR

2 phase stepper motor

3 phase stepper motor

Hercules motor

Waterproof motor

Encoder motor

Brake motor

Planetary gearbox motor

Outdoor anti-rust motor

Dimensions :HEM-34D series

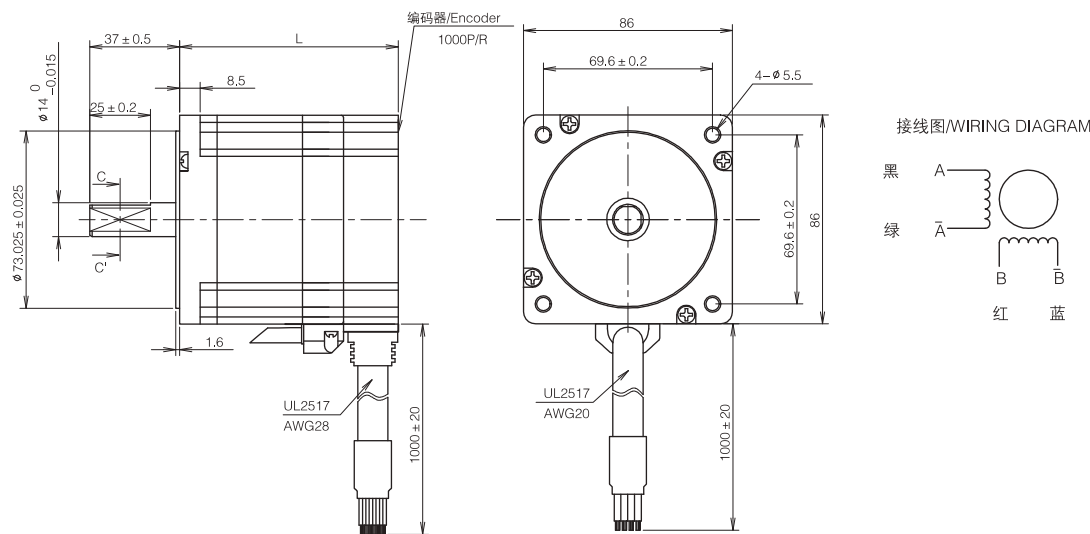

Dimensions :HEM-23D series

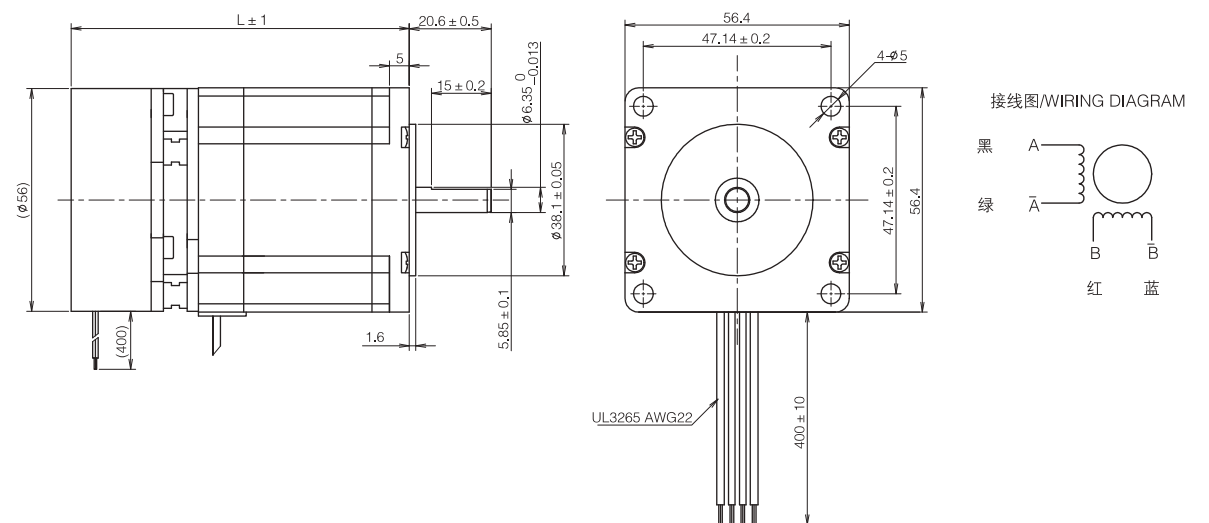

步进驱动器  
STEPPER DRIVE

HEM-24D(□60)/34D(□86) Brake motor

Parameters:

Model code	Brake specifications		Holding torque (N.m)	Current (A)	Resistance (Ohm)	Rotor inertia (g.cm <sup>2</sup> )	Weight (Kg)	Length(mm)
	Power(DC)	Torque(N.m)						
HEM-24D5007-02BK	24V	1.5	3.0	4.0	0.6	900	1.8	119
HEM-34D1801-10BK	24V	5.2	5.4	6.0	0.6	1400	3.2	114.5
HEM-34D3803-13BK	24V	5.2	11.8	6.0	0.8	2500	4.8	154.5

Dimensions :HEM-24D5007-02BK

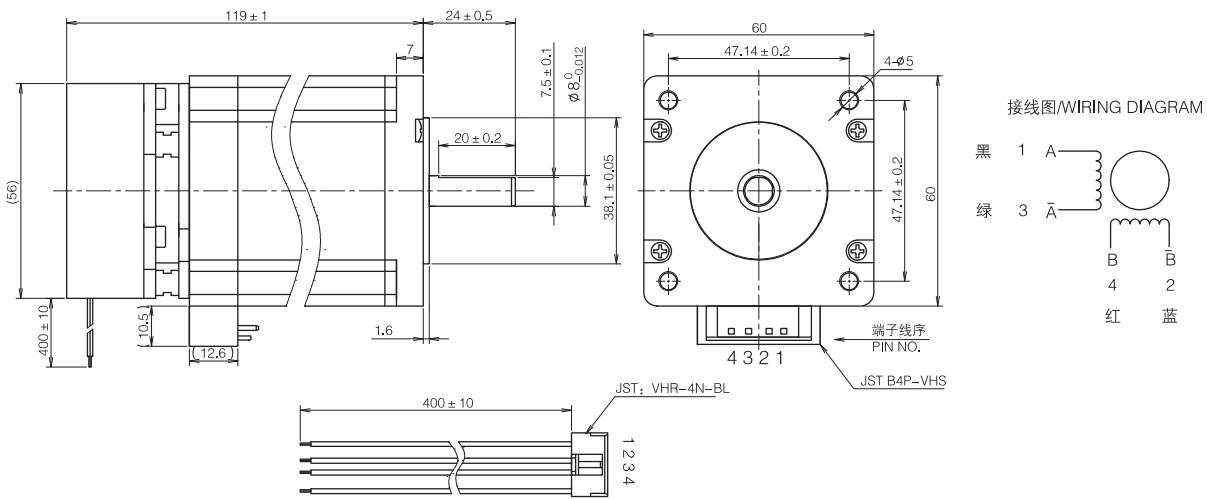

2 phase DC

2 phase AC

3 phase DC

3 phase AC

步进电机  
STEPPER MOTOR

2 phase stepper motor

3 phase stepper motor

Hercules motor

Waterproof motor

Encoder motor

Brake motor

Planetary gearbox motor

Outdoor anti-rust motor

步进驱动器  
STEPPER DRIVE

HEM-11D(□28)/14D(□35) Planetary gearbox motor

Parameters:

Model code	Poles	Current (A)	Resistance (Ohm)	Arc	Efficiency (%)	Power (W)	Torque (N.m)	Length (mm)	Weight (Kg)		
										HEM-11D6003-01PG	4
HEM-11D6003-03PG	9	1.2	1.3	25Arc	90%	0.14	0.8	5.7	22	0.31	86.4
HEM-11D6003-04PG	20	2.7	2.8	25Arc	90%	0.14	0.8	5.7	22	0.31	86.4
HEM-14D6001-05PG	4	1.3	1.3	15Arc	95%	0.33	1.0	3.7	22	0.32	78.1
HEM-14D6001-06PG	9	2.8	3.0	25Arc	90%	0.33	1.0	3.7	22	0.34	86.1
HEM-14D6001-07PG	20	6.3	6.6	25Arc	90%	0.33	1.0	3.7	22	0.34	86.1

Dimensions :HEM-11D6003 series

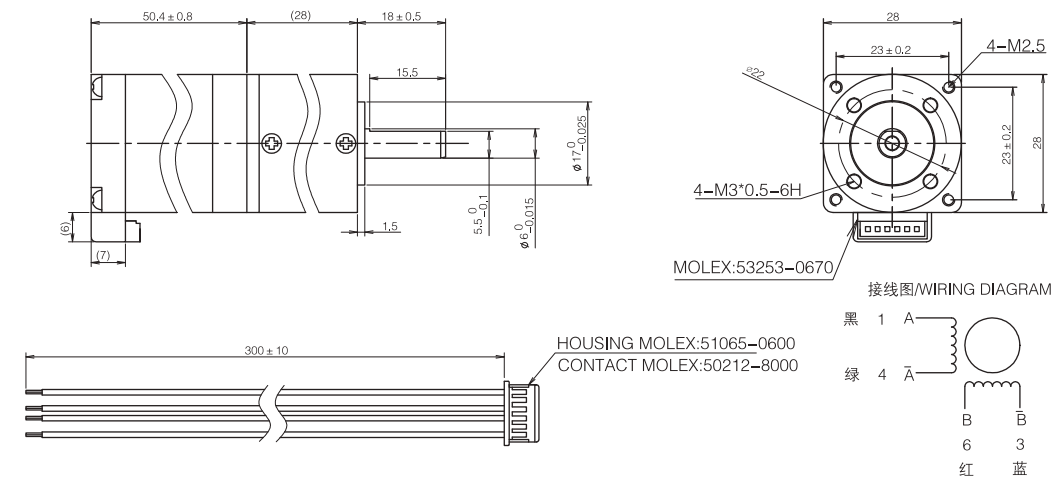

2 phase DC

2 phase AC

3 phase DC

3 phase AC

步进电机  
STEPPER MOTOR

2 phase stepper motor

3 phase stepper motor

Hercules motor

Waterproof motor

Encoder motor

Brake motor

Planetary gearbox motor

Outdoor anti-rust motor

Dimensions :HEM-34D series

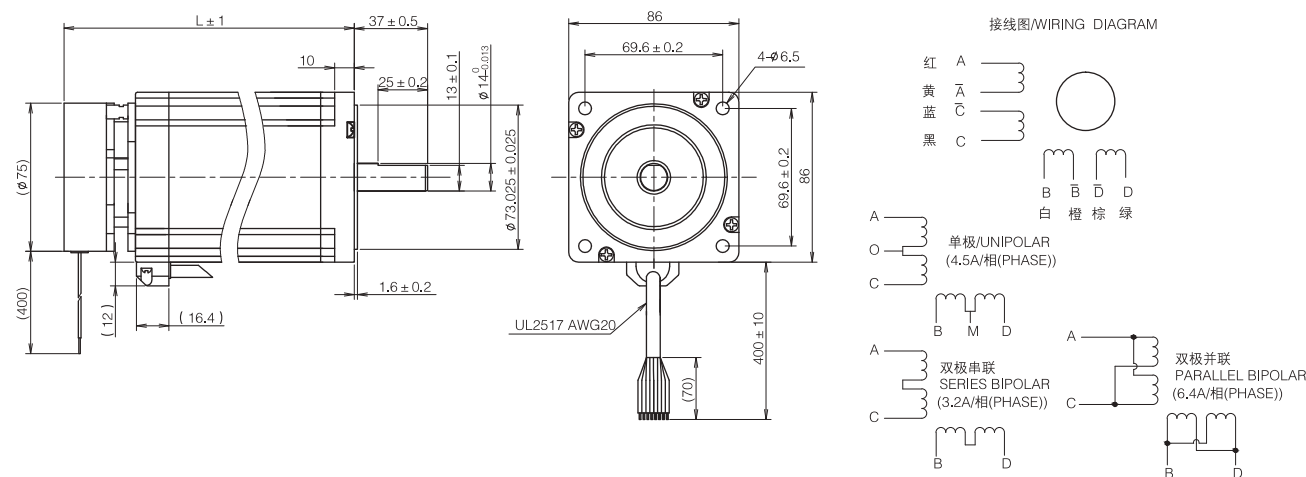

Dimensions :HEM-14D6001 series

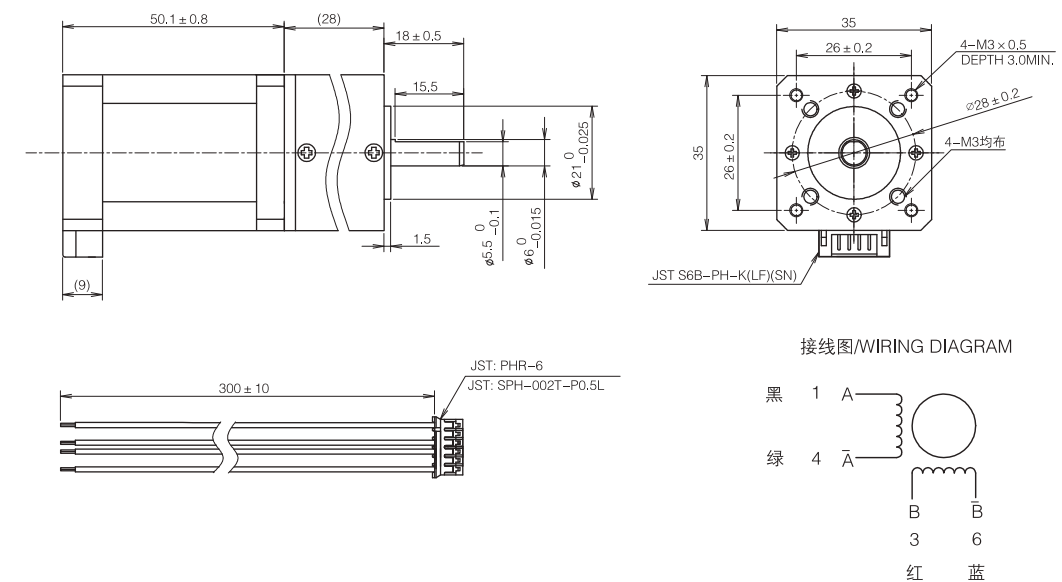

步进驱动器  
STEPPER DRIVE

HEM-17D(□42)/24D(□60) Planetary gearbox motor

Parameters:

Model code	Gearbox parameter					Motor parameter					
	Reduction ratio	Rated Torque (N.m)	Max torque (N.m)	Return difference	Efficiency	Holding torque (N.m)	Current (A)	Resistance (Ω)	Rotor inertia (g.cm <sup>2</sup> )	Weight (Kg)	Length(mm)
HEM-17D6005-10PG	5	2.3	2.5	15Arc	95%	0.49	2.0	1.0	82	0.76	89.7
HEM-17D6005-11PG	10	4.7	4.9	15Arc	95%	0.49	2.0	1.0	82	0.76	89.7
HEM-17D6005-12PG	20	9.3	9.8	30Arc	90%	0.49	2.0	1.0	82	0.96	99.7
HEM-17D6005-13PG	50	23.3	24.5	30Arc	90%	0.49	2.0	1.0	82	0.96	99.7
HEM-24D5004-03PG	5	14.3	15	15Arc	95%	3.0	4.2	0.75	810	2.2	140.1
HEM-24D5004-04PG	10	28.5	30	15Arc	95%	3.0	4.2	0.75	810	2.2	140.1
HEM-24D5004-05PG	20	57	60	30Arc	90%	3.0	4.2	0.75	810	2.5	157.1
HEM-24D5004-06PG	50	143	150	30Arc	90%	3.0	4.2	0.75	810	2.5	157.1
HEM-24D5004-07PG	100	285	300	30Arc	90%	3.0	4.2	0.75	810	2.5	157.1

Dimensions :HEM-17D6005 series

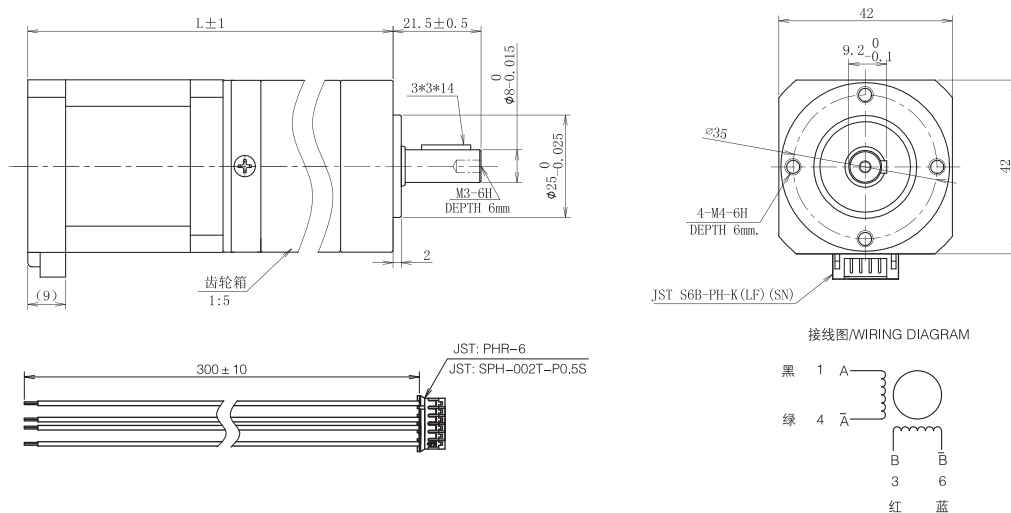

Dimensions :HEM-24D5004 series

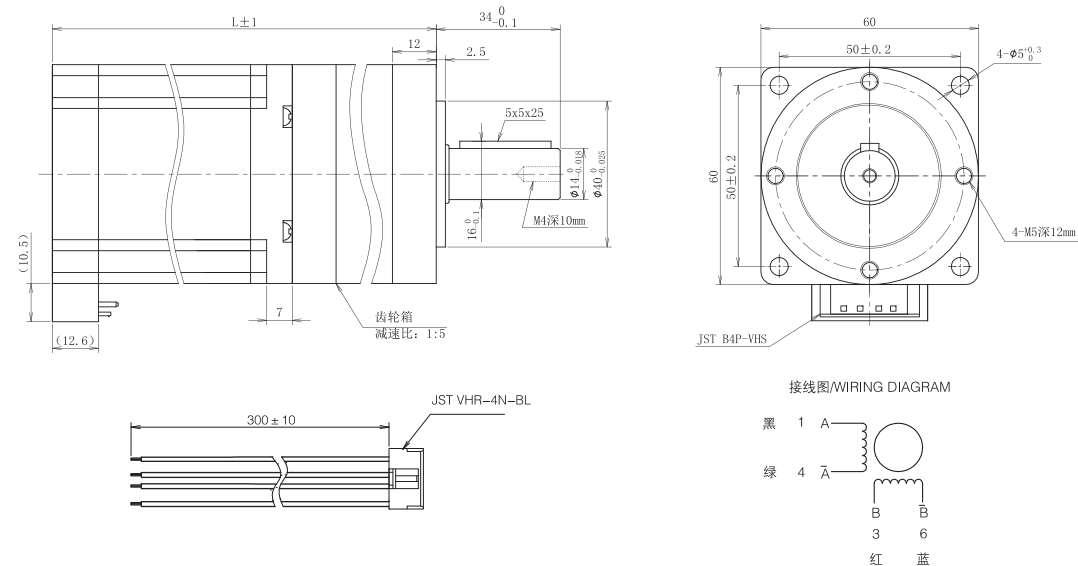

Outdoor anti-rust motor

Hemm motor is a suitable solution for high temperature, high humidity or high salinity environments, such as Marine ships, outdoor drenching, solar energy systems in the desert and so on.



2 phase DC

2 phase AC

3 phase DC

3 phase AC

步进电机  
STEPPER MOTOR

2 phase stepper motor

3 phase stepper motor

Hercules motor

Waterproof motor

Encoder motor

Brake motor

Planetary gearbox motor

Outdoor anti-rust motor

步进驱动器  
STEPPER DRIVE

2 phase DC

2 phase AC

3 phase DC

3 phase AC

步进电机  
STEPPER MOTOR

2 phase stepper motor

3 phase stepper motor

Hercules motor

Waterproof motor

Encoder motor

Brake motor

Planetary gearbox motor

Outdoor anti-rust motor

■ Damper 、 Gearbox



Damper



Gearbox

■ Pulley 、 Gear



Pulley

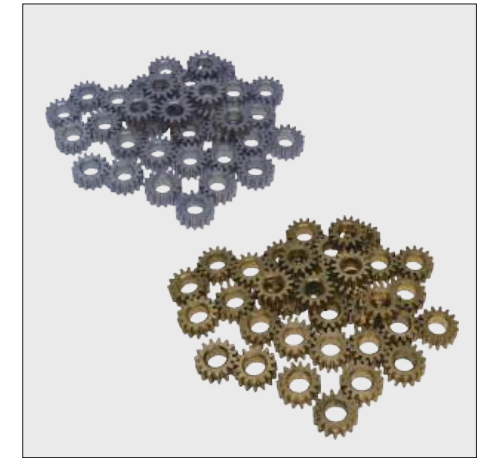

Gear

■ Flexible coupling、 Connection Cables



Flexible coupling

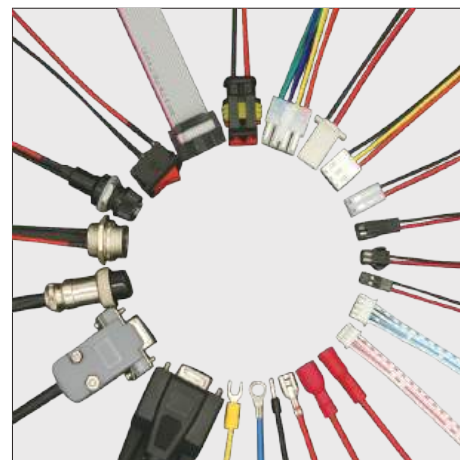

Connection Cables

■ Encoder、 Brake



Encoder



Brake

Damper

Damper

Gearbox

Gearbox

Flexible coupling

Flexible coupling

Connection Cables

Connection Cables

Pulley

Pulley

Gear

Gear

Encoder

Encoder

Brake

Brake

### Customer demand list

### Motor sketches

Company: \_\_\_\_\_ Department: \_\_\_\_\_  
 Name: \_\_\_\_\_ Tel: \_\_\_\_\_  
 E-mail: \_\_\_\_\_  
 Address: \_\_\_\_\_

---

Motor selection requirements:  
 Application: \_\_\_\_\_  
 Dimensional: \_\_\_\_\_ Current: \_\_\_\_\_ Torque: \_\_\_\_\_  
 Notes to other requirements:

---

Step driver selection requirements:  
 Application: \_\_\_\_\_ Choose the supporting motor model:  Yes  No  
 Dimensional: \_\_\_\_\_ Voltage: \_\_\_\_\_ Current: \_\_\_\_\_  
 Installation direction:  vertical  horizontal  
 Communication mode:  RS232  RS485  CAN  Ethercat  other  
 Notes to other requirements:

